

COUNTY OF LOS ANGELES
ROAD DEPARTMENT

PRECISE
BENCH MARK LIST



COVINA QUAD
1965 ADJUSTMENT

PREFACE

The Road Department level net is composed of more than 1,000 miles of levels supporting in excess of 10,000 bench marks. In 1964-65, a major readjustment of the net was undertaken. To emphasize the complete break with previous elevations, the SY, SG & SL series bench marks have been re-labeled BY, BG & BL, respectively.

To facilitate the adjustment, indexing, and distribution of adjusted values of the net, the County territory was divided into 31 quads or areas. For identification purposes each quad was given a name, viz., "Rosemead," "La Mirada," "Santa Fe," etc. When bench marks and elevations in the Road Department net are used, the name of the quad in which the bench mark is located and the date of the adjustment of the elevation must be included in the bench mark description, e.g.,

BG 1887 --L+BN IN CONC HDWL OF DRAIN PIPE UNDER DR 218 FT
NE +18 FT SE C/L INT SAN JOSE HILLS RD +CAMERON AVE MKD (BM)
(COVINA --1965) ELEV. 696.238

It is expected that this general adjustment will, for the most part, remain sound for the next 8 to 12 years. As new circuits are completed, however, re-adjustment of individual quads may become advisable. It is expected that these subsequent adjustments will be in the nature of a few hundredths of a foot. When a quad is re-adjusted, new elevation lists will be published and the date of the re-adjustment will replace the "1965" at the end of the bench mark description. Two bench marks in the same quad with different adjustment dates will not normally join each other. Since all adjustments taper out to nothing at the periphery of the quad, any bench mark in one quad will join any bench mark in another quad regardless of their respective adjustment dates.

The basic accuracy of the net is reflected by an indicated field probable error of plus or minus 0.012 foot per mile of leveling as determined from 298 conditions of closure. However, many years experience in vertical control in the greater Los Angeles basin and Antelope Valley indicate that because of varying degrees of subsidence and heaving, the true datum is recovered only by obtaining substantial agreement of a number of bench marks.

The users of this net are invited to assist in its maintenance by notifying this Department of cases of obliteration, apparent mistakes in descriptions or elevations, and proven disturbance of bench marks.

DATUM: U. S. Coast and Geodetic Survey Sea Level Datum
of 1929, through the medium of the Los Angeles
County Engineer Precise Level Net, 1963 Adjust-
ment.

Abbreviations Used in Bench Mark Listings

ABUT--Abutment	L+BN--Lead and Bench Mark Nail
ANG PT--Angle Point	L+BR--Lead and Brad
BC--Beginning of Curve	L+N--Lead and Nail
BCR--Beginning of Curb Return	L+PK--Lead and PK Nail
BLDG--Building	L+SPK--Lead and Spike
BT SPK--Boat or Bolt Spike	L+T--Lead and Tack
CB RET--Curb Return	MCR--Middle of Curb Return
C/L INT--Center Line Intersection	MKD--Marked
C/L PROD--Center Line Produced	NR--Near
COE--Corps of Engineers	OPP--Opposite
CONC--Concrete	PI--Point of Intersection
CS MON--County Surveyor Monument	PK+W--PK Nail and Washer
CS BR CAP--County Surveyor Brass Cap Monument	P/L--Property Line
CT SPK--Cut Spike	P O S T--Point on Semi-tangent
CTR--Center	PP--Power Pole
DN--Down	PVMT--Pavement
DR--Driveway	R D--Road Department
EC--End of Curve	RDBM--Road Department Bench Mark
ENT--Entrance	RR--Railroad
FC--Flood Control (Dept. LA County)	SPK T+W--Spike, Tin and Washer
FTG--Footing	USC+GS--United States Coast and Geodetic Survey
HDWL--Headwall	USGS--United States Geological Survey
HSE--House	WK--Walk
IP--Iron Pipe	±--Plus or Minus
LACE--Los Angeles City Engineer	+--And

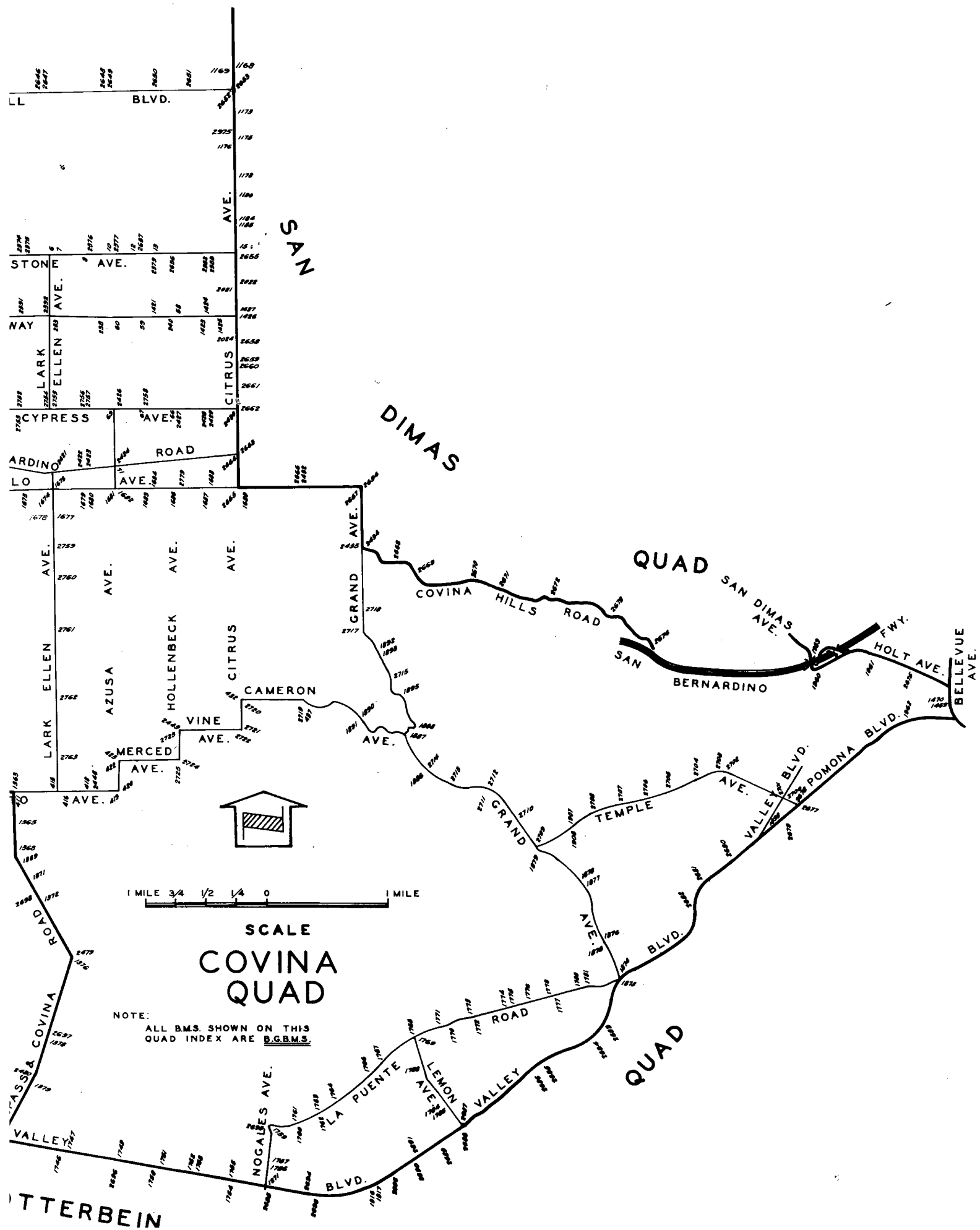

SAN DIMAS

DIMAS

QUAD

SAN DIMAS AVE.

SAN BERNARDINO

FWY.

HOLT AVE.

BELLEVUE AVE.



SCALE
COVINA
QUAD

NOTE:
ALL B.M.S. SHOWN ON THIS
QUAD INDEX ARE B.G.B.M.S.

QUAD

BUTTERBEIN

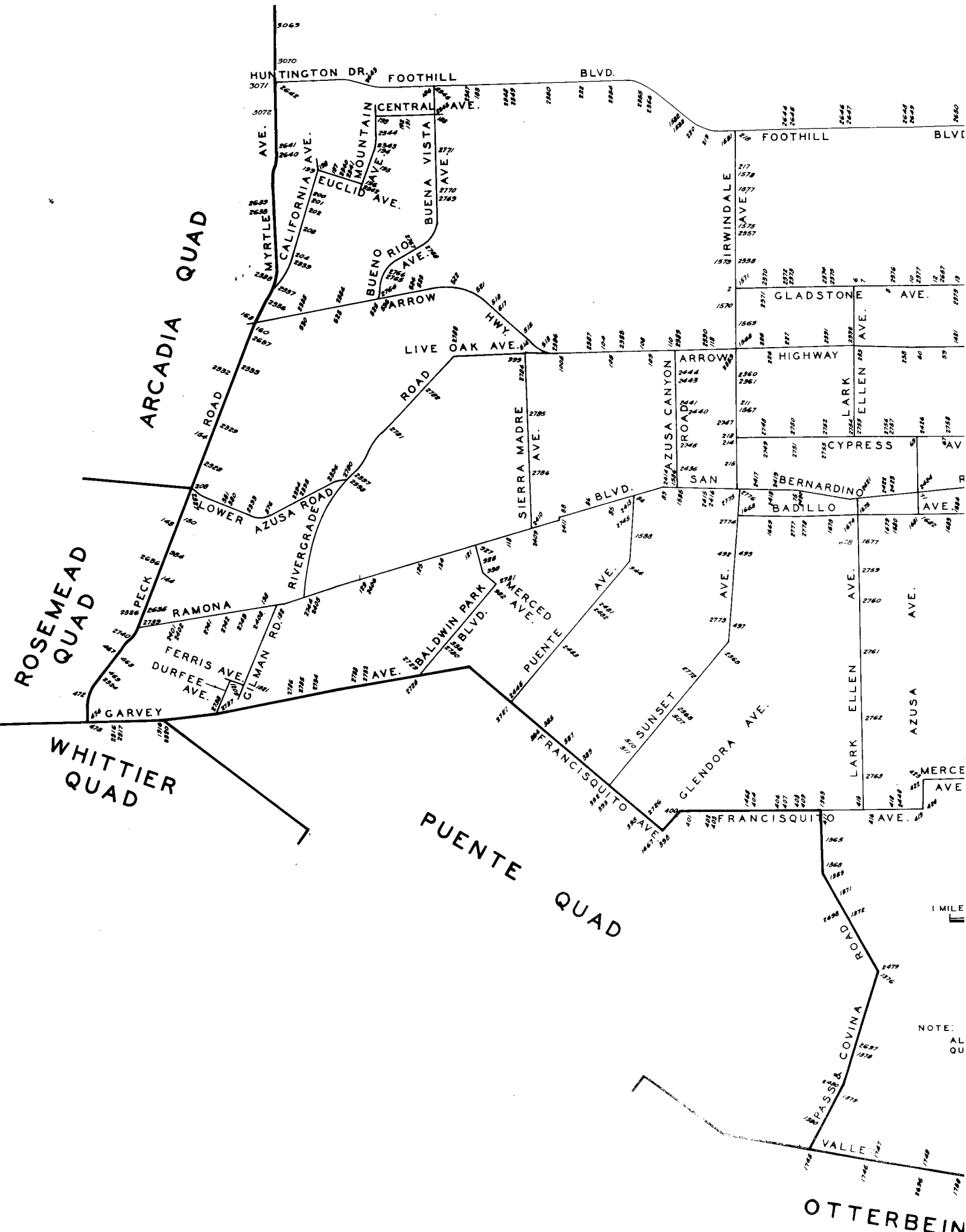

ARCADIA QUAD

ROSEMEAD QUAD

WHITTIER QUAD

PUENTE QUAD

OTTERBEIN

1 MILE

NOTE:
AL
QU

QUAD-YEAR	ELEV	DESCRIPTION (INCLUDE QUAD AND YEAR IN DESCRIPTION)	BM NUMBER
COVINA (1965)	497.972	L+T W CB IRWINDALE AVE 60FT N C/L GLADSTONE ST 30FT N END OF CB	BG 2
COVINA (1965)	506.248	RDBM TAG N CB 2FT W BCR @ NW COR GLADSTONE ST + VERNON AVE (LARK ELLEN AVE) 30FT N + 65FT W C/L INT	BG 6
COVINA (1965)	505.961	L+T N CB 16FT BCR @ NE COR GLADSTONE ST + VERNON AVE (LARK ELLEN AVE) 75FT E + 30FT N C/L INT	BG 7
COVINA (1965)	512.640	L+N IN NE COR OF WEST BCR @ 30FT S C/L GLAD- STONE ST 75FT W C/L SUNSET AVE	BG 8
COVINA (1965)	517.976	L+BN N CB 1FT W BCR @ NW COR GLADSTONE ST + AZUSA AVE 30FT N + 70FT W C/L INT	BG 10
COVINA (1965)	536.797	L+T W CB 1FT N BCR @ NW COR GLADSTONE ST + PASADENA AVE 66FT N + 20FT W C/L INT	BG 12
COVINA (1965)	551.640	CS REF MON 6IN DN IN ISLAND @ NE COR GLAD- STONE ST + CERRITOS AVE 40FT N + 115FT E C/L INT MKD (GLENORA RM NO1)	BG 13
BASELINE (1965)	587.368	DISC TOP OF CONC ST 1FT DN UNDER CS CASTIRON CAP 65FT E + 12FT C/L INT CITRUS AVE + GLADSTONE ST	BG 15
COVINA (1965)	545.650	RD MON @ OIL INT CERRITOS AVE + ARROW HWY	BG 58
COVINA (1965)	530.572	L+T CTR CB RET @ SW COR ARROW HWY + ARMEL DR	BG 59
COVINA (1965)	520.860	L+BN W END OF GAS STA @ 105FT E C/L AZUSA AVE + 75FT S C/L ARROW HWY	BG 60
BASELINE (1965)	564.340	BT SPK E CB 5FT S C/L @ SE COR CITRUS AVE + CYPRESS ST 62FT W 30FT E C/L INT MKD (SD 137)	BG 64
COVINA (1965)	529.208	SQ HD SPK W CB 3FT N BCR @ SW COR CYPRESS ST + HOLLENBECK AVE 65FT S + 35FT W C/L INT	BG 66
COVINA (1965)	514.424	L+T 15FT W BCR @ SW COR ELSPETH WAY + CYPRESS ST	BG 67
COVINA (1965)	501.270	RDBM TAG W CB 2FT S BCR @ SW COR CYPRESS ST + AZUSA AVE 42FT W + 69FT S C/L INT	BG 69
COVINA (1965)	492.057	L+FLAT SPK E CB 45FT S BCR @ SE COR AZUSA AVE + SAN BERNARDINO RD 106FT S 43FT E C/L INT	BG 71
COVINA (1965)	437.458	L+BN CB 48FT S C/L @ SE COR SAN BERNARDINO RD + VINCENT AVE 30FT E 123FT S C/L INT	BG 75
COVINA (1965)	403.275	L+N IN CTR E CB RET OF ENT TO COVINA WATER CO 31FT S C/L SAN BERNARDINO RD	BG 83
COVINA (1965)	396.441	L+T IN E END PUMP ISLAND OF GAS STATION @ SE COR E RAMONA BLVD + PUENTE AVE	BG 84
COVINA (1965)	389.055	L+BN NE COR CONC SLAB OF BLDG 51FT S C/L E RAMONA BLVD + 4FT E C/L PROD PARK PL MKD (BM)	BG 85
COVINA (1965)	382.244	L+N IN W CB DOWNING AVE 95FT N C/L OF E ROMONA BLVD S OF ALLEY	BG 86

QUAD-YEAR	ELEV	DESCRIPTION (INCLUDE QUAD AND YEAR IN DESCRIPTION)	BM NUMBER
COVINA (1965)	375.825	L+T IN CTR CB RET NW COR MAINE AVE + RAMONA BLVD N OF PERR	BG 88
COVINA (1965)	440.958	CS MON IN WELL 8IN DN @ C/L INT ARROW HWY + HEINTZ ST MKD (AZUSA F18)	BG 104
COVINA (1965)	442.198	CS REF MON FLUSH IN CONC SLAB ON SE COR ARROW HWY + HEINTZ ST 55FT S + 35FT E C/L INT MKD (AZUSA F18)	BG 105
COVINA (1965)	453.848	L+T IN CONC RET WALL S SIDE ARROW HWY 45FT E OF GATE TO HSE NO 15250	BG 108
COVINA (1965)	455.064	L+T NE COR CONC STEP FRONT OF BLDG NO 15260 45FT S C/L ARROW HWY	BG 109
COVINA (1965)	458.805	L+BN CONC FOOTING OF FEN COR @ NW COR ARROW HWY + AZUSA CN RD 48FT N + 18FT W C/L INT. MKD (BM)	BG 110
COVINA (1965)	465.442	L+N SW COR OF NEAR E P/L 4TH ST 83FT N C/L ARROW HWY	BG 113
COVINA (1965)	357.092	RDBM TAG S CB 1FT W BCR @ SW COR RAMONA BLVD + STEWART AVE 41FT W + 35FT S C/L INT	BG 118
COVINA (1965)	347.814	L+T 1FT N BCR @ SW COR IDAHO ST + W RAMONA BLVD	BG 121
COVINA (1965)	338.594	L+T 4FT E BCR @ SE COR GRACE AVE + W RAMONA BLVD	BG 124
COVINA (1965)	336.364	L+T @ BCR @ SE COR FOSTER AVE + W RAMONA BLVD	BG 125
COVINA (1965)	325.728	RDBM TAG 1FT S BCR @ SW COR RAMONA BLVD + SAN FRANCISQUITO AVE 65FT S + 30FT W C/L INT	BG 129
COVINA (1965)	320.922	CS MON IN WELL 14IN DN 18FT S C/L RAMONA BLVD + 108FT E OF BRIDGE OVER RIVERGRADE MKD (PUENTE A3)	BG 132
COVINA (1965)	318.086	L+N IN E END GAS ISLAND GAS STA NO 12357 RAMONA BLVD 2FT N C/L PVMT 218158 W RAMONA BLVD + 300FT W OF BRIDGE	BG 133
BASELINE (1965)	308.608	L+T @ SW COR DRIVEWAY 48FT E C/L PECK RD + 100FT S C/L BASYE ST	BG 144
BASELINE (1965)	331.672	L+T MC COR PECK RD + HEMLOCK ST	BG 154
BASELINE (1965)	352.326	L+BN 3FT S BCR @ SE COR PECK RD + LIVE OAK AVE	BG 160
BASELINE (1965)	352.698	CS MON 21 FT W C/L PECK RD + 30FT N C/L LIVE OAK AVE	BG 163
COVINA (1965)	506.326	L+N 3FT S BCR @ SE COR BRYCEDALE AVE + HUNTINGTON DR	BG 183
COVINA (1965)	509.733	BT SPK W CB 40FT S BCR @ SW COR HUNTINGTON DR + BUENA VISTA ST 108FT S + 30FT W C/L INT	BG 184
COVINA (1965)	479.908	L+T IN CENTRAL AVE 30FT S C/L + 20FT E C/L BUENA VISTA ST	BG 188

QUAD-YEAR	ELEV	DESCRIPTION (INCLUDE QUAD AND YEAR IN DESCRIPTION)	BM NUMBER
COVINA (1965)	486.351	L+T IN W CB @ SW COR BROADLAND AVE + CENTRAL AVE	BG 191
COVINA (1965)	488.090	L+T 1FT @ SE COR BRADBURY AVE + CENTRAL AVE	BG 192
COVINA (1965)	489.368	L+T NR N EDGE FIRST CONC STEP TO W HSE ENT NO 906 @ SE COR CENTRAL AVE + MOUNTAIN AVE	BG 193
COVINA (1965)	455.508	L+T IN CTR @ SE COR DUARTE RD + MOUNTAIN AVE	BG 194
COVINA (1965)	440.267	L+T IN E CB 6FT N BCR @ NE COR MOUNTAIN AVE + HURST VIEW ST	BG 195
COVINA (1965)	421.255	L+T IN SW COR CONC ENT TO STORE NO 1974 55FT E C/L MOUNTAIN AVE	BG 196
COVINA (1965)	419.239	L+T IN CONC DRWY TO HSE NO 2003 @ SW COR EUCLID AVE + WESLEY GROVE AVE	BG 197
COVINA (1965)	419.944	L+T IN SE COR DRWY OF HSE NO 2003 @ SW COR FLAGSTONE AVE + EUCLID AVE	BG 198
COVINA (1965)	424.305	L+T IN W CB CALIFORNIA AVE 15FT N C/L PROC EUCLID AVE	BG 199
COVINA (1965)	400.562	L+T IN CTR CB RET NW COR JOELLA ST + CALIFORNIA AVE	BG 200
COVINA (1965)	396.858	L+T IN CTR CB RET @ NW COR EL SUR ST + CALIFORNIA AVE	BG 201
COVINA (1965)	393.262	L+T IN CTR CB RET @ NW COR MAYDEE ST + CALIFORNIA AVE	BG 202
COVINA (1965)	388.229	L+N IN W EDGE FIRST CONC STEP HSE NO 403 @ NE COR CALIFORNIA AVE + PAMELA ST	BG 203
COVINA (1965)	375.865	L+T IN CTR CB RET @ NW COR BRISBANE ST AND CALIFORNIA AVE	BG 204
COVINA (1965)	447.340	L+N IN CONC BASE OF N GATE POST @ ENT TO TRANSIT MIX CONCRETE CO 120FT E C/L IRWINDALE AVE	BG 211
COVINA (1965)	433.268	CS TAG N CB 1FT E BCR @ NW COR IRWINDALE AVE CYPRESS ST 76FT W + 30FT N C/L INT	BG 213
COVINA (1965)	432.776	SO HD SPK S CB 6FT W BCR @ SW COR IRWINDALE AVE + CYPRESS ST 80FT W + 30FT S C/L INT MKD (BM HV 87)	BG 214
COVINA (1965)	428.538	L+T IN CONC WALK FRONT OF HSE NO 751 50FT W C/L IRWINDALE AVE + 40FT S C/L KINGSIDE DR	BG 215
COVINA (1965)	566.258	L+BN @ SE COR CONC TO POWER BOX 11FT S OF S RAIL SFRR + 10FT E C/L IRWINDALE AVE	BG 217
COVINA (1965)	585.756	L+BM TAG IN E CB 1FT @ SE COR FOOTHILL BLVD + IRWINDALE 20FT + 75FT S C/L INT	BG 218
COVINA (1965)	592.672	L+N IN S CB BRIDGE ON FOOTHILL BLVD OVER SAN GABRIEL RIVER @ SE END OF BRIDGE	BG 219
COVINA (1965)	590.948	L+SPK 4FT FROM SW END BRIDGE NO 53-21 ON FOOTHILL BLVD OVER SAN GABRIEL RIVER 1FT FROM CONC RAILING	BG 220

QUAD-YEAR	ELEV	DESCRIPTION (INCLUDE QUAD AND YEAR IN DESCRIPTION)	BM NUMBER
COVINA (1965)	532.509	L+T E CB ELMHURST AVE 1FT S BCR @ SE COR FOOTHILL BLVD 70FT S + 17FT E C/L INT	BG 222
COVINA (1965)	474.703	RDBM TAG CONC DR 70FT N C/L ARROW HWY + 130FT W C/L MORADA ST	BG 225
COVINA (1965)	471.993	RD MON IN WELL 8IN DN @ C/L INT ARROW HWY + MORADA ST	BG 226
COVINA (1965)	474.038	CS MON IN WELL 10IN DN @ C/L INT ARROW HWY + VINCENT AVE MKD (SEC COR 3 4 9 10 R10W T1S)	BG 227
COVINA (1965)	484.849	CS REF MON IN CONC FLUSH @ SE COR LARK ELLEN AVE + ARROW HWY 45FT S + 45FT E C/L INT MKD (RM NC2 AZUSA K-12)	BG 233
COVINA (1965)	518.877	L+BN @ NE COR CONC SLAB OF GAS STA NO 17356 53FT S C/L ARROW HWY + 102FT W C/L AZUSA AVE	BG 238
COVINA (1965)	546.095	RDBM TAG E CB 7FT S BCR @ SE COR ARROW HWY + HOLLENBECK AVE 30FT E + 77FT S C/L INT	BG 240
COVINA (1965)	330.835	L+T 18FT E BCR @ NE COR FRANCISQUITO AVE + BALDWIN PARK BLVD	BG 338
COVINA (1965)	324.836	CS MON IN WELL 9IN DN C/L INT ROSEGLEN ST + LOWER AZUSA RD TO E	BG 376
COVINA (1965)	326.087	L+T CONC DR OF HSE NO 11741 40FT N C/L LOWER AZUSA RD + 750FT W LA MADERA AVE MKD (8M)	BG 381
BASELINE (1965)	336.268	L+T IN W CB OF WILLOW AVE 1FT N BCR @ NW COR FRANCISQUITO AVE 20FT W + 64FT N C/L INT	BG 385
BASELINE (1965)	337.533	RDBM TAG IN N CB FRANCISQUITO AVE 2FT E BCR @ NE COR RAMA DR 30FT N + 57FT E OF C/L INT	BG 387
BASELINE (1965)	338.506	PK IN E CB ORANGE AVE 2FT S BCR @ SE COR FRANCISQUITO AVE 66FT S + 18FT E C/L INT	BG 389
BASELINE (1965)	341.454	RDBM TAG CB 6FT E C/L PROD N END OF SERVICE RD 50FT S C/L FRANCISQUITO AVE + 55FT W C/L SUNSET AVE	BG 392
BASELINE (1965)	341.570	L+BRAD 6FT E BCR 30FT S C/L FRANCISQUITO AVE + 80FT E C/L SUNSET AVE	BG 393
BASELINE (1965)	343.209	L+BRAD 3FT E OF CATCH BASIN 30FT S C/L FRANCISQUITO AVE + 55FT W C/L CALIFORNIA AVE	BG 395
BASELINE (1965)	345.364	RDBM TAG IN CB 75FT S C/L FRANCISQUITO AVE 30FT E C/L HACIENDA BLVD	BG 398
BASELINE (1965)	354.082	CS MON @ C/L INT FRANCISQUITO AVE + HACIENDA BLVD	BG 400
BASELINE (1965)	356.215	L+T 2IN E BCR @ SE COR GRIFFITHS AVE + FRANCISQUITO AVE	BG 401
BASELINE (1965)	363.125	L+N @ BCR @ SW COR MULLENDER AVE + FRANCISQUITO AVE	BG 402
BASELINE (1965)	363.165	L+N @ S BCR @ SE COR MULLENDER AVE + FRANCISQUITO AVE	BG 403

QUAD-YEAR	ELEV	DESCRIPTION (INCLUDE QUAD AND YEAR IN DESCRIPTION)	BM NUMBER
BASELINE (1965)	371.914	SQ HD SPK IN N CB OF CATCH BASIN @ NE COR FRANCISQUITO AVE + WALNUT AVE 18FT N + 40FT E C/L INT MKD (AZ 202)	BG 404
BASELINE (1965)	382.250	L+T 1FT S BCR @ SW COR INDIAN SUMMER AVE + FRANCISQUITO AVE	BG 406
BASELINE (1965)	382.583	L+T 2FT S BCR @ SE COR INDIAN SUMMER AVE + FRANCISQUITO AVE	BG 407
BASELINE (1965)	390.237	CS TRI MON C/L INT FRANCISQUITO AVE + VALINDA AVE N MKD (PUENTE J6)	BG 408
BASELINE (1965)	392.479	SQ HD SPK E CB 6FT S BCR @ SE COR FRANCISQUITO AVE + VALINDA AVE 53FT S + 30FT E C/L INT MKD (A2207)	BG 409
BASELINE (1965)	407.060	L+BN S CB 10FT E BCR 20FT S + 55FT E C/L INT PASS+ COVINA RD + FRANCISQUITO AVE	BG 411
COVINA (1965)	429.452	CS MON @ C/L INT FRANCISQUITO AVE + LARK ELLEN AVE (S EDGE)	BG 415
COVINA (1965)	431.821	RE TAG NO 1797 S CB 3FT W BCR @ SE COR FRANCISQUITO AVE + LARK ELLEN AVE 21FT S + 62 FT E OF C/L INT	BG 416
COVINA (1965)	463.547	L+T N CB 1FT W BCR @ NW COR FRANCISQUITO AVE + GLENVIEW RD 20FT N + 46FT W C/L INT	BG 418
COVINA (1965)	494.950	L+SPK 4FT FROM N OF CB 20FT W C/L AZUSA AVE 30FT S C/L FRANCISQUITO AVE	BG 419
COVINA (1965)	493.968	L+T IN S CB OF DR HSE NO 1811 21FT W C/L AZUSA AVE 30FT N C/L FRANCISQUITO AVE	BG 420
COVINA (1965)	466.144	RAMSET S CB 6FT W BCR @ SW COR AZUSA AVE + MERCED AVE 80FT W + 30FT S C/L INT	BG 422
COVINA (1965)	467.505	NAIL IN CONC POST IN WELL 8IN DN @ C/L INT AZUSA AVE + MERCED AVE	BG 423
COVINA (1965)	526.804	L+T IN CTR OF CTR N SIDE OF DR SW COR CITRUS AVE + CAMDEN AVE	BG 432
BASELINE (1965)	288.364	L+BN CTR HDWL 34 FT W C/L PECK RD + 32FT N OF N RAIL SPRR	BG 467
BASELINE (1965)	288.513	L+BN CTR HDWL 34 FT W C/L PECK RD + 37FT N OF N RAIL SPRR	BG 468
BASELINE (1965)	283.439	RD HD NAIL IN LIN STEEL WASHER @ E BCR + W END OF CATCH BASIN @ NE COR PECK RD + VALLEY BLVD	BG 469
BASELINE (1965)	276.824	L+T IN W CB 3FT S CATCH BASIN @ NW COR PECK RD + MEEKER AVE	BG 472
BASELINE (1965)	273.384	L+T 8FT E OF CONC DR TO GAS STA @ NW COR GARVEY AVE + PECK RD	BG 474
BASELINE (1965)	273.320	L+BN 1FT W BCR @ SW COR GARVEY AVE + PECK RD	BG 475
COVINA (1965)	407.281	L+BN S CB 3FT E BCR 70FT W C/L SUNSET AVE 30FT S C/L PUENTE AVE	BG 492
COVINA (1965)	406.687	BT SPK E CB 20FT S BCR 77FT S C/L PUENTE AVE + 40FT E C/L SUNSET AVE	BG 493

QUAD-YEAR	ELEV	DESCRIPTION (INCLUDE QUAD AND YEAR IN DESCRIPTION)	BM NUMBER
COVINA (1965)	391.989	BT SPK E CB 11FT S BCR @ SE COR SUNSET AVE + WORKMAN AVE 40FT E + 44FT S C/L INT MKD (BM)	BG 497
COVINA (1965)	362.042	L+PK S CB 60FT E BCR @ SE COR SUNSET AVE + MERCED AVE 30FT S + 135FT E C/L INT	BG 507
COVINA (1965)	348.071	L+N W CB 3FT N BCR @ NW COR SUNSET AVE + FARLINGTON ST 60FT N + 40FT W C/L INT	BG 510
COVINA (1965)	347.893	L+T S CB 1FT W BCR @ SW COR SUNSET AVE + FARLINGTON ST 20FT S + 75FT W C/L INT	BG 511
COVINA (1965)	425.997	L+T S CB TRAFFIC ISLAND 15FT E OF W END 200FT NW C/L INT ARROW HWY + LIVE OAK AVE + 600FT NW OF MAINE AVE + ARROW HWY	BG 513
COVINA (1965)	421.929	L+BN ANG PT OF 6FT CHAIN LINK FEN @ END OF R R TRACK IN CONC PIPE YD 36FT S C/L ARROW HWY + 1500FT W MAINE AVE MKD (BM)	BG 514
COVINA (1965)	424.280	L+BN S EDGE OF CONC PVMT OF SERVICE RD UP SANTA FE DAM 30FT N C/L ARROW HWY	BG 515
COVINA (1965)	433.303	L+T CONC ABUT @ NE COR ARROW HWY BRIDGE OVER SANTA FE DAM SPILLWAY	BG 517
COVINA (1965)	433.295	L+T CONC ABUT @ NW COR ARROW HWY BRIDGE OVER SANTA FE DAM SPILLWAY	BG 518
COVINA (1965)	411.952	R D MON @ P O S T 300FT E EC ARROW HWY 15FT N C/L + 150FT E EDISON POWER LINE CROSSING	BG 521
COVINA (1965)	404.608	L+BN CTR CONC HDWL 33FT N C/L ARROW HWY + 700FT W OF CURVE TO SE NR SANTA FE DAM	BG 522
COVINA (1965)	391.200	L+T CONC HDWL 1FT W OF E END OF WALL 30FT N C/L ARROW HWY + 650FT E C/L BUENO RIO DR	BG 523
COVINA (1965)	390.251	R D MON 69FT SE PP NO 804653E 40FT SW OF CONC HDWL + 625FT E C/L INT BUENO RIO DR + ARROW HWY	BG 524
COVINA (1965)	388.118	R D MON @ C/L INT ARROW HWY + BUENO RIO DR	BG 525
COVINA (1965)	388.428	C S MON FLUSH 50FT S C/L ARROW HWY + 10FT E C/L BUENO RIO DR	BG 526
COVINA (1965)	374.737	R D MON @ C/L INT ARROW HWY + LIVE OAK AVE	BG 528
COVINA (1965)	359.597	L+T IN CONC PVMT 1FT SW C/L INT LONGDEN AVE + LIVE OAK AVE	BG 530
COVINA (1965)	349.417	L+BN S CB 1FT E BCR @ SE COR RAMONA BLVD + MERCED AVE	BG 927
COVINA (1965)	348.967	L+T IN S EDGE OF CONC CURB TO HSE NO 1802 50FT N + 38FT E C/L INT MERCED AVE + ILLINOIS ST	BG 928
COVINA (1965)	346.827	CS MON @ C/L INT MERCED AVE + FRAZIER ST	BG 930
COVINA (1965)	348.825	L+T IN CONC WK 28FT N + 29FT SE C/L INT MERCED AVE + BALDWIN BLVD	BG 932

QUAD-YEAR	ELEV	DESCRIPTION (INCLUDE QUAD AND YEAR IN DESCRIPTION)	BM NUMBER
COVINA (1965)	377.188	RD MON @ PI ON PUENTE AVE 55FT NE C/L INT PUENTE AVE + CENTRAL AVE	BG 944
BASELINE (1965)	313.497	RDBM TAG E CB 1FT S BCR @ NE COR PECK RD + LAMBERT AVE 50FT N + 39FT E C/L INT	BG 984
COVINA (1965)	417.188	L+BN CONC FOUNDATION COR FENCE POST @ SW COR ARROW HWY + SIERRA MADRE AVE	BG 999
COVINA (1965)	427.092	L+T E CB 45FT S BCR @ SE COR MAIN AVE @ SE COR MAINE AVE @ SE COR ARROW HWY	BG 1005
BASELINE (1965)	655.439	CS MON @ C/L INT FOOTHILL BLVD TO E + CITRUS AVE S	BG 1168
BASELINE (1965)	655.924	L+T E WALL OF DRAIN 30FT N C/L FOOTHILL BLVD TO E 17FT W C/L PROD CITRUS AVE 25FT N DR TO HSE NO 6843	BG 1169
BASELINE (1965)	626.216	FC BR CAP W RET WALL 75FT N LITTLE DALTON WASH + 18FT W C/L CITRUS AVE	BG 1173
BASELINE (1965)	616.107	L+BN N CB ALOSTA AVE 33FT W BCR @ NW COR CITRUS AVE 100FT W + 40FT N C/L INT	BG 1175
BASELINE (1965)	616.544	L+SPK E CB CITRUS AVE 10FT S BCR @ SE COR ALOSTA AVE 30FT E + 104FT S C/L INT	BG 1176
BASELINE (1965)	609.285	RDBM TAG N CB MAUNA LOA AVE 6FT E BCR @ NE COR CITRUS AVE 18FT N + 72FT E C/L INT	BG 1178
BASELINE (1965)	599.439	L+BN E CB CITRUS AVE 30FT S BCR @ SE COR BASE LINE RD 30FT W + 87FT S C/L INT	BG 1180
BASELINE (1965)	591.844	L+T N CB NEARFIELD ST 5 FT S BCR @ NE COR CITRUS AVE 70FT E + 18FT N C/L INT	BG 1184
BASELINE (1965)	591.704	L+BRAD S CB NEARFIELD ST 1FT E BCR @ SE COR CITRUS AVE 64FT E + 18FT S C/L INT	BG 1185
COVINA (1965)	303.624	L+T N EDGE CONC WK TO HSE NO 3560 DURFEE AVE 43FT E C/L @ SE COR FERRIS RD (3FT E OF END OF WK)	BG 1209
BASELINE (1965)	456.320	R D MON IN WELL 10 IN DN @ C/L INT VALLEY BLVD + NOGALES ST	BG 1271
BASELINE (1965)	487.479	L+BN S SIDE OF CONC BASE OF RR X SIGNAL 12FT S OF S RAIL SPRR + 25FT E C/L WATER ST	BG 1316
BASELINE (1965)	487.221	L+BN IN CONC BASE OF RR X SIGNAL 15FT N OF N RAIL SPRR + 20FT W C/L WATER ST + 60FT S C/L VALLEY BLVD MKD (50-57A)	BG 1317
BASELINE (1965)	405.173	CS MON IN WELL @ C/L INT PASS + COVINA RD + FRANCISQUITO AVE	BG 1363
BASELINE (1965)	412.127	L+BN E CB PASS + COVINA RD 144FT S C/L DOUBLEGROVE ST	BG 1365
BASELINE (1965)	428.146	L+BN S CB 2FT E BCR @ SE COR MAPLEGROVE ST + PASS + COVINA RD	BG 1368
BASELINE (1965)	439.007	CS MON IN WELL C/L PASS + COVINA RD 400FT SE OF PI S OF MAPLEGROVE ST NR WATER RESERVOIR MKD (BM 37-5 1954 RE 63)	BG 1369
BASELINE (1965)	412.351	L+BN S END OF CONC 17FT E C/L PASS + COVINA RD 51FT N PP NO 6843	BG 1371

QUAD-YEAR	ELEV	DESCRIPTION (INCLUDE QUAD AND YEAR IN DESCRIPTION)	BM NUMBER
BASELINE (1965)	426.871	CS MON IN WELL @ C/L INT AMAR RD + PASS + COVINA RD	BG 1372
BASELINE (1965)	400.798	FC MON IN N END HDWL 14FT E + 470FT N C/L INT PASS + COVINA RD + T M P L U VE MKD (BM 100-26 1948)	BG 1376
BASELINE (1965)	449.679	L+BN CTR CB RET OF SERV RD GEMINI ST 45FT E C/L PASS + COVINA RD	BG 1378
BASELINE (1965)	435.126	L+BN CTR CB RET OF SERV RENAULT ST 45FT E C/L PASS + COVINA RD	BG 1379
COVINA (1965)	539.391	L+BN S CB ARROW HWY SERV RD 170FT E DR TO HSE NO 610 + 585FT W CERRITOS AVE	BG 1421
COVINA (1965)	561.988	L+T N CB SERV RD 33FT W BCR @ SW COR FENIMORE AVE + ARROW HWY	BG 1423
COVINA (1965)	561.799	L+BN S CB SERV RD 2FT W BCR @ SW COR FENIMORE AVE + ARROW HWY	BG 1424
COVINA (1965)	569.327	L+BN S CB ARROW HWY 95FT E OF DR TO HSE NO 18252 670FT W CITRUS AVE	BG 1425
BASELINE (1965)	578.138	C S MON @ C/L CITRUS AVE 20FT S C/L ARROW HWY MKD (SEC COR 2 1 11 12 TIS R10W)	BG 1426
BASELINE (1965)	580.676	L+T SIDE CONC BASE OF LIGHT STANDARD 50FT N C/L ARROW HWY + 54FT E C/L CITRUS AVE	BG 1427
BASELINE (1965)	345.485	CS MON C/L INT FRANCISQUITO AVE TO W + HACIENDA BLVD	BG 1467
BASELINE (1965)	370.340	CS MON 6FT E + 1FT N C/L INT FRANCISQUITO AVE + WALNUT AVE	BG 1468
BASELINE (1965)	785.441	BRONZE DISK IN CTR OF CONC ABUT OF SPRR CULV 8FT N OF TRACKS 250FT W INT VERNON AVE + BELLEVUE AVE	BG 1469
BASELINE (1965)	794.707	L+T CTR OF S CURVE OF PKWY OF CORONA FRWY @ INT OF BELLEVUE AVE	BG 1470
COVINA (1965)	438.464	CS MON IN WELL 12FT E C/L IRWINDALE AVE + 0.5 MI S ARROW HWY ON N P/L PROD HSE NO 4748 MKD (BM 16-2 1952 RE 63)	BG 1567
COVINA (1965)	467.305	CS MON IN WELL 6IN DN @ C/L INT ARROW HWY + IRWINDALE AVE	BG 1568
COVINA (1965)	476.137	L+BN IN CONC BASE OF 3IN FENCE POST 48FT E C/L IRWINDALE AVE 66FT SE OF PP NO 464297E + 600FT N ARROW HWY	BG 1569
COVINA (1965)	490.001	L+BN IN CONC FOUNDATION OF COR FENCE POST @ S ENT TO CONCRETE CONDUIT CO 27FT W C/L IRWINDALE AVE + 700FT S GLADSTONE ST	BG 1570
COVINA (1965)	496.925	CS MON @ NE COR IRWINDALE AVE + GLADSTONE ST 23FT FROM S END + 10FT W OF E CB	BG 1571
COVINA (1965)	513.555	BR MON S CB 4FT W BCR @ SW COR IRWINDALE AVE + PARAMOUNT ST 34FT S + 55FT W C/L INT MKD (AZUSA 58-3)	BG 1573
COVINA (1965)	526.970	CS MON IN WELL 29FT E C/L IRWINDALE AVE + 22FT S OF S CB 1ST ST MKD (BM 11-22 1952 RE 63)	BG 1575

QUAD-YEAR	ELEV.	DESCRIPTION (INCLUDE QUAD AND YEAR IN DESCRIPTION)	BM	NUMBER
COVINA (1965)	547.020	L+BN IN CONC BASE TO COR POST OF CHAIN LINK FENCE 33FT E C/L IRWINDALE AVE 27FT N + 11FT E OF TP NO 14176Y + 1300FT N 1ST ST	BG	1577
COVINA (1965)	566.316	BOLT WITH X @ W EDGE OF CONC JUNCT BCX 10FT S OF S RAIL OF MAINLINE SFRR + 70FT E C/L IRWINDALE AVE	BG	1578
COVINA (1965)	585.230	L+BM TAG IN W CB 21FT BCR @ SW COR IRWINDALE AVE + FOOTHILL BLVD 60FT W + 60FT S C/L INT	BG	1581
COVINA (1965)	576.161	STATE HWY MON IN WELL 1 1/2 IN DN @ C/L INT HUNTINGTON DR + CROWNHAVEN DR (FISH CANYON RD)	BG	1582
COVINA (1965)	575.766	RDBM TAG IN W CB 1FT S BCR @ SW COR HUNTINGTON DR + CROWNHAVEN DR 90FT S + 18FT W C/L INT	BG	1583
COVINA (1965)	405.458	L+T IN S CB SAN BERNARDINO RD 30FT S C/L @ C/L PROD AZUSA CANYON RD	BG	1585
COVINA (1965)	405.635	L+BN IN W CB 5FT S BCR @ NW COR SAN BERNARDINO RD + AZUSA CANYON RD 60FT N + 21FT W C/L INT	BG	1586
COVINA (1965)	380.826	CS MON IN WELL 10 1/2 IN DN @ C/L INT CLEARY DR + PUENTE AVE	BG	1588
COVINA (1965)	414.339	SQ HD SPK N CB 6FT E BCR 75FT N C/L BADILLO ST + 115FT E C/L IRWINDALE AVE MKD (HV 64)	BG	1668
COVINA (1965)	422.454	BT SPK E CB 6FT N BCR 108FT N C/L BADILLO ST + 15FT E C/L ELLEN DR MKD (HV 76)	BG	1669
COVINA (1965)	446.640	RDBM TAG E CB 57FT N BCR 20FT E C/L CARVCL AVE + 95FT N C/L ELGENIA AVE	BG	1673
COVINA (1965)	458.421	RDBM TAG W CB 2FT S BCR 75FT S C/L BADILLO ST + 30FT W C/L LARK ELLEN AVE	BG	1674
COVINA (1965)	461.747	L+T CONC WK TO CHURCH @ NE COR BADILLO ST + LARK ELLEN AVE 75FT N + 133FT E C/L INT MKD (BM)	BG	1675
COVINA (1965)	450.299	CS MON IN WELL @ C/L INT LARK ELLEN AVE + PUENTE AVE MKD (CS RE 03)	BG	1677
COVINA (1965)	449.797	PK IN E CB 17FT S BCR 18FT S C/L PUENTE AVE + 25FT E C/L LARK ELLEN AVE	BG	1678
COVINA (1965)	468.876	RDBM TAG W CB 24FT S BCR 60FT S C/L BADILLO ST + 18FT W C/L LEAF AVE	BG	1679
COVINA (1965)	472.076	RDBM TAG N CB 50FT N C/L BADILLO ST + 200FT E C/L LEAF AVE	BG	1680
COVINA (1965)	487.884	L+BRAD W CB 16FT S BCR 48FT W C/L AZUSA AVE + 60FT N C/L BADILLO ST MKD (BM C59)	BG	1681
COVINA (1965)	488.245	ST HWY MON IN WELL 8IN DN C/L INT BADILLO ST + AZUSA AVE MKD (L-2)	BG	1682
COVINA (1965)	504.726	RDBM TAG E CB 3FT S BCR 18FT E C/L ARMEL DR + 115FT S C/L BADILLO ST	BG	1683
COVINA (1965)	505.468	RDBM TAG E CB 31FT BCR 18FT E C/L ARMEL DR + 110FT N C/L BADILLO ST	BG	1684
COVINA (1965)	517.105	L+T E CB 15FT S BCR 20FT E C/L HOLLENBECK AVE + 60FT S C/L BADILLO ST	BG	1686

QUAD-YEAR	ELEV	DESCRIPTION (INCLUDE QUAD AND YEAR IN DESCRIPTION)	BM NUMBER
COVINA (1965)	528.240	RDBM TAG W CB 18FT S BCR 15FT W C/L FOURTH AVE + 65FT S C/L BADILLO ST	BG 1687
COVINA (1965)	528.893	RDBM TAG W CB 14FT N BCR 25FT W C/L FOURTH AVE + 65FT N C/L BADILLO ST	BG 1688
BASELINE (1965)	546.047	USC+GS BR DISC 4FT ABOVE WALK IN N FACE OF BLDG @ SE COR BADILLO ST CITRUS AVE 2FT FROM NW COR MKD (USC+GS BM NO 35)	BG 1689
BASELINE (1965)	379.341	RD MON IN WELL 7IN DN @ C/L INT VALLEY BLVD + PASS + COVINA RD	BG 1745
BASELINE (1965)	390.096	RD MON IN WELL 8IN DN ON C/L INT VALLEY BLVD + HAMBLEDON AVE	BG 1746
BASELINE (1965)	389.843	L+T N CB VALLEY BLVD 3FT E BCR @ NE COR HAMBLEDON AVE 36FT N + 47FT E C/L INT	BG 1747
BASELINE (1965)	398.416	L+T N CB 6FT BCR 15FT N C/L VALLEY BLVD + 46FT E C/L GIARDINO AVE	BG 1749
BASELINE (1965)	412.372	L+BN IN RR SIGNAL BASE 75FT S C/L VALLEY BLVD + 35FT W C/L YORBITA RD	BG 1750
BASELINE (1965)	410.050	RDBM TAG CTR CONC HDWL 43FT N C/L VALLEY BLVD + 25FT E C/L YORBITA RD	BG 1751
BASELINE (1965)	419.894	RDBM TAG W CB 11FT N BCR 81FT N C/L VALLEY BLVD + 20FT W C/L LA SEDA RD	BG 1752
BASELINE (1965)	419.960	L+T E CB 12FT N BCR 82FT N C/L VALLEY BLVD + 20FT E C/L LA SEDA RD	BG 1753
BASELINE (1965)	429.646	L+BN E END CONC HDWL 70FT S C/L VALLEY BLVD + 0.2MI E LA SEDA RD MKD (BM 12)	BG 1754
BASELINE (1965)	432.923	RDBM TAG N CB 1FT W CATCH BASIN 40FT N VALLEY BLVD + 0.2 MI E LA SEDA RD	BG 1755
COVINA (1965)	458.697	L+T IN CONC WK TO HSE NO 537 NOGALES ST 60FT E C/L + 0.2 MI N VALLEY BLVD MKD (BM)	BG 1756
COVINA (1965)	453.904	L+T CONC SLAB TO FRONT DCOR TO HSE NO 537 NOGALES ST 94FT W C/L + 0.25 MI N VALLEY BLVD MKD (BM)	BG 1757
COVINA (1965)	458.322	RDBM TAG CONC WINGWALL OF CULV 70FT S C/L LA PUENTE RD + 130FT E C/L ROAD NOGALES ST	BG 1759
COVINA (1965)	471.484	RDBM TAG IN CONC WINGWALL OF CATCH BASIN 52FT S C/L LA PUENTE RD + 0.2 MI E NOGALES ST	BG 1760
COVINA (1965)	478.885	RDBM TAG IN CONC WINGWALL OF CATCH BASIN 30FT N C/L LA PUENTE RD + 0.2 MI E NOGALES ST	BG 1761
COVINA (1965)	496.366	RDBM TAG IN NW COR CONC RESERVOIR 43FT S C/L LA PUENTE RD + 0.4 MI E NOGALES ST	BG 1762
COVINA (1965)	497.058	RDBM TAG IN CONC WINGWALL OF CATCH BASIN 25FT N C/L LA PUENTE RD + 0.4 MI E NOGALES ST	BG 1763
COVINA (1965)	514.577	RDBM TAG IN CONC WINGWALL OF CATCH BASIN 28FT N C/L LA PUENTE RD + 0.6 MI E NOGALES ST	BG 1764
COVINA (1965)	572.553	RDBM TAG IN CONC HDWL OF CULV 24FT N C/L LA PUENTE RD + 1.1 MI E NOGALES ST	BG 1766
COVINA (1965)	579.365	L+BN IN CONC FOOTING OF 2IN CONC POST 30FT N LA PUENTE RD + 1.2MI E NOGALES ST	BG 1767

QUAD-YEAR	ELEV	DESCRIPTION (INCLUDE QUAD AND YEAR IN DESCRIPTION)	BM NUMBER
COVINA (1965)	568.145	CS MON IN WELL 9IN DN @ C/L INT LEMON AVE + LA PUENTE RD	BG 1768
COVINA (1965)	565.061	3/4IN STEEL STUD ON WINDWALL OF BRIDGE NO B166 18FT S C/L LA PUENTE RD + 176FT E C/L LEMON AVE MKD (BM)	BG 1769
COVINA (1965)	568.851	RDBM TAG IN W HDWL OF DR TO HSE NO 20205 LA PUENTE RD 16FT N C/L + 0.25 MI E LEMON AVE	BG 1770
COVINA (1965)	568.883	RDBM TAG IN E HDWL OF DR TO HSE NO 20205 LA PUENTE RD 16FT N C/L + 0.25 MI E LEMON AVE	BG 1771
COVINA (1965)	581.788	L+BN IN W HDWL OF DR TO HSE NO 20505 LA PUENTE RD 24FT N C/L + 0.6 MI E LEMON AVE	BG 1772
COVINA (1965)	582.336	L+BN IN E HDWL OF DR TO HSE NO 20505 LA PUENTE RD 24FT N C/L + 0.6 MI E LEMON AVE	BG 1773
COVINA (1965)	577.802	L+T IN CONC HDWL @ NW COR LA PUENTE RD + PIERRE RD 25FT N + 30FT W C/L INT MKD (BM)	BG 1774
COVINA (1965)	577.807	L+T IN CONC HDWL @ NE COR LA PUENTE RD + PIERRE RD 25FT N + 16FT E C/L INT MKD (BM)	BG 1775
COVINA (1965)	584.267	RDBM TAG IN CONC HDWL 24FT N C/L LA PUENTE RD + 198FT E C/L SUZANNE RD	BG 1776
COVINA (1965)	603.577	L+T CONC WK TO HSE NO 524 @ NE COR GARTEL DR + BENIK PL 31FT N + 30FT E C/L INT MKD (BM)	BG 1777
COVINA (1965)	604.259	L+T IN CONC DR TO HSE NO 524 @ NE COR GARTEL DR + BENIK PL 20FT N + 76FT E C/L INT MKD (BM)	BG 1778
COVINA (1965)	621.246	RDBM TAG IN E END OF CONC HDWL 24FT N C/L LA PUENTE RD + 0.15 MI E GARTEL DR	BG 1780
COVINA (1965)	616.874	RDBM TAG NR CTR OF CONC HDWL 24FT N C/L LA PUENTE RD + 0.2 MI W SAN JOSE HILLS RD	BG 1781
COVINA (1965)	546.703	RDBM TAG IN N CONC ABUT OF BRIDGE NO 169 16FT W C/L LEMON AVE + 110FT S C/L VEJAR RD	BG 1783
COVINA (1965)	533.961	L+BN CONC STAND OFF 46FT W C/L LEMON AVE + 10FT N C/L PROD CANREY RD	BG 1784
COVINA (1965)	534.660	L+BN CONC STAND OFF 21 FT LEMON AVE 92FT W C/L + 25 FT S C/L PROD CANREY RD (BM)	BG 1785
BASELINE (1965)	604.209	CS MON IN WELL 30IN DN NR CTR TRAFFIC ISL @ INT VALLEY BLVD LA PUENTE RD + GRAND AVE MKD (BM 11-95)	BG 1873
COVINA (1965)	609.539	RD MON IN WELL 6IN DN @ PI GRAND AVE 195FT N C/L VALLEY BLVD	BG 1874
COVINA (1965)	633.886	RDBM TAG CTR CONC HDWL 30FT W C/L GRAND AVE + 0.45MI N VALLEY BLVD	BG 1875
COVINA (1965)	638.428	RD MON IN WELL 8IN DN @ PI GRAND AVE 22FT W C/L + 0.6MI N VALLEY BLVD	BG 1876
COVINA (1965)	711.268	RD MON IN WELL 6IN DN @ PI GRAND AVE 18FT E C/L + 1.1MI N VALLEY BLVD	BG 1878
COVINA (1965)	722.691	RD MON IN WELL 4IN DN ON C/L PROD TEMPLE AVE 57FT W C/L GRAND AVE	BG 1879

QUAD-YEAR	ELEV	DESCRIPTION (INCLUDE QUAD AND YEAR IN DESCRIPTION)	BM NUMBER
COVINA (1965)	871.688	L+T @ ANG PT OF E CONC HWY OF BRIDGE NO 574 20FT S C/L SAN JOSE HILLS RD 1.6MI N TEMPLE AVE	BG 1886
COVINA (1965)	696.238	L+BN IN N CONC HDWL OF DRAIN PIPE UNDER DR 218 FT NE + 18FT SE C/L INT SAN JOSE HILLS RD CAMERON AVE MKD (BM)	BG 1887
COVINA (1965)	702.181	CS MON IN WELL 8IN DN @ 368FT NE C/L INT SAN JOSE HILLS RD + CAMERON AVE @ C/L BC	BG 1888
COVINA (1965)	647.114	RDBM TAG N CB 90FT E + 12FT N C/L INT CAMERON AVE + PVD ST 0.5MI S BARRANCA ST	BG 1890
COVINA (1965)	547.739	L+T W CB 1FT N BCR @ NW COR SUNSET HILL DR + GRAND AVE	BG 1892
COVINA (1965)	558.621	L+BN W CB GRAND AVE 40FT W C/L + 400FT S SUNSET HILL DR	BG 1893
COVINA (1965)	669.169	L+T S CB DR TO HSE N CRIST OF HILL 33FT E C/L CAMERON AVE + 0.6MI S IN GRAND AVE + GOLDEN BOUGH DR	BG 1895
BASELINE (1965)	684.146	CS MON IN WELL 12IN DN 8FT W OF W EDGE PVMT POMONA BLVD + 8FT E OF E EDGE PVMT VALLEY BLVD MKD (BM 11-91)	BG 1898
COVINA (1965)	729.530	RDBM TAG @ SE COR BONITA DR + TEMPLE AVE IN CONC FOOTING OF GATE @ ENT TO CATTLE YARD 50FT S + 140FT E C/L INT	BG 1907
BASELINE (1965)	287.948	CS MON IN WELL 8IN DN ON C/L VALLEY BLVD + 27FT S C/L GARVEY AVE MKD (EL MONTE J5 RE 2177)	BG 1916
COVINA (1965)	301.826	CS MON IN WELL 12IN DN 5FT E + 5FT S C/L INT FERRIS RD + GILMAN RD MKD (EL MONTE L4)	BG 1921
BASELINE (1965)	787.478	RDBM TAG N END OF ABUT OF BRIDGE NO 5 OVER SAN BERNARDINO FREEWAY 15FT W C/L SAN DIMAS AVE	BG 1959
BASELINE (1965)	786.503	RDBM TAG S END OF ABUT OF BRIDGE NO 5 OVER SAN BERNARDINO FREEWAY 15FT E C/L SAN DIMAS AVE	BG 1960
BASELINE (1965)	768.342	CS MON IN WELL 11IN DN @ C/L ROSECRANS ST 130FT SE C/L HOLT AVE MKD (BM 17-21 1952)	BG 1961
BASELINE (1965)	771.121	RD BR CAP S HDWL 8FT S OF S RAIL + 11FT NE C/L PROD POMONA + COVINA RD NR INT POMONA BLVD + POMONA + COVINA RD + SECOND ST	BG 1962
BASELINE (1965)	584.582	FC MON IN SW WINGWALL OF BRIDGE B1237 ON CITRUS AVE OVER BIG DALTON WASH 37FT W C/L MKD (BM 81-39)	BG 2021
BASELINE (1965)	585.060	L+BRAD E CB CITRUS AVE @ NE END OF BRIDGE B1237 OVER BIG DALTON WASH 30FT E C/L	BG 2022
BASELINE (1965)	572.286	L+SPK W CB 40FT W C/L CITRUS AVE + 57FT N OF N END BRIDGE B1228 OVER SAN DIMAS WASH	BG 2024
BASELINE (1965)	280.266	L+T S CB 1FT W BCR @ SW COR GARVEY AVE + MEEKER AVE 32FT W + 38FT S C/L INT	BG 2316
BASELINE (1965)	280.474	L+BN S CB 3FT E BCR @ SE COR GARVEY AVE + MEEKER AVE 38FT S + 34FT E C/L INT	BG 2317
BASELINE (1965)	290.238	RDBM TAG S CB 30FT S C/L GARVEY AVE @ ENT TO UNDERPASS OF RR 450FT E VALLEY BLVD	BG 2320

QUAD-YEAR	ELEV	DESCRIPTION (INCLUDE QUAD AND YEAR IN DESCRIPTION)	BM NUMBER
BASELINE (1965)	282.696	CS MON IN WELL 8IN DN @ NE COR PECK RD + VALLEY BLVD 40FT N + 64FT E C/L INT MKD (BM 15-1)	BG 2324
BASELINE (1965)	297.326	RDBM TAG SE COR CONC TEL M H @ SE COR PECK RD + FOREST GROVE ST 22FT S + 68FT E C/L INT	BG 2326
BASELINE (1965)	321.998	CS MON IN WELL 9IN DN @ SE COR PECK RD + LOWER AZUSA RD 1 FT BACK OF CB FACE + 47FT E + 63FT S C/L INT MKD (BM 15-4)	BG 2327
BASELINE (1965)	329.935	CS MON 50FT E C/L PECK RD + 47FT S C/L CHERRYLEE DR MKD (LOT 7)	BG 2328
BASELINE (1965)	336.864	L+T CONC PORCH OF BLDG @ SW COR PECK RD + RIO HONDO PKWY 147FT S + 78FT W C/L INT MKD (BM)	BG 2329
BASELINE (1965)	338.435	FC MON IN N END OF CB ON BRIDGE NO B 1270 40FT W C/L PECK RD + 1000FT N CLARK ST MKD (BM 67-75)	BG 2332
BASELINE (1965)	339.136	RDBM TAG CONC WALL OF WASH @ NE COR BRIDGE NO B1270 5FT E CB + 45FT E C/L PECK RD + 1000FT N CLARK ST	BG 2333
COVINA (1965)	359.263	CS MON IN WELL 12IN DN IN ISL NR INT LONGDEN AVE + ARROW HWY 27FT N + 40FT W C/L INT MKD (A-11)	BG 2335
BASELINE (1965)	357.353	RD MON IN WELL 6IN DN @ INT MYRTLE AVE + LONGDEN AVE	BG 2336
BASELINE (1965)	364.152	L+T E CB MYRTLE AVE 40FT E C/L + 37FT S BCR OF ISL + 66FT S C/L CALIFORNIA AVE EXIT	BG 2337
BASELINE (1965)	365.065	FC TAG W CB MYRTLE AVE 40FT W C/L + 1FT S CATCH BASIN + 46FT N OF CALIFORNIA AVE EXIT	BG 2338
COVINA (1965)	375.354	L+T W CB 4FT S BCR @ SW COR CALIFORNIA AVE + BRISBANE ST 15FT W + 60FT S C/L INT	BG 2339
COVINA (1965)	421.693	FC MON S CB NR BCR @ SW COR EUCLID AVE + GOODALL AVE 45FT W + 18FT S C/L INT	BG 2340
COVINA (1965)	423.668	RDBM TAG N CB 1FT E BCR @ NE COR EUCLID AVE + SHAMROCK AVE 18FT N + 49FT E C/L INT	BG 2341
COVINA (1965)	419.463	SQ HD SPK E CB 25FT S BCR @ SE COR MOUNTAIN AVE + ALLEY OPP EUCLID AVE 20FT E + 83FT S C/L INT MKD (KK 222)	BG 2342
COVINA (1965)	455.485	SQ HD SPK E CB 5FT S BCR @ SE COR BUENARTE RD + CITRUS VIEW AVE 15FT E + 85FT C/L INT MKD (KK 204)	BG 2343
COVINA (1965)	481.402	RDBM TAG E CB 33FT E C/L MOUNTAIN AVE + 318FT S C/L CENTRAL AVE	BG 2344
COVINA (1965)	481.127	L+T N CB 3FT E FUTURE BCR @ NE COR BUENA VISTA ST + CENTRAL AVE 56FT E + 20FT C/L INT	BG 2345
COVINA (1965)	510.077	CS MON FLUSH 3FT S OF S CB FACE @ SE COR HUNTINGTON DR + BUENA VISTA ST 45FT S + 66FT E C/L INT MKD (BM 11-14A)	BG 2346
COVINA (1965)	507.473	RDBM TAG S CB 4FT W BCR @ SW COR HUNTINGTON DR + BRYCEDALE ST 43FT S + 48FT W C/L INT	BG 2347
COVINA (1965)	534.278	RDBM TAG S CB 2FT W BCR @ SW COR HUNTINGTON DR + HIGHLAND AVE 60FT W + 43FT S C/L INT	BG 2348

QUAD-YEAR	ELEV	DESCRIPTION (INCLUDE QUAD AND YEAR IN DESCRIPTION)	BM NUMBER
COVINA (1965)	533.560	RDBM TAG S CB 1FT E BCR @ SE COR HUNTINGTON DR + HIGHLAND AVE 60FT E + 42FT S C/L INT	BG 2349
COVINA (1965)	523.120	USC+GS MON IN WELL 24IN DN 2FT S OF S CB HUNTINGTON DR 44FT S C/L + 0.2MI E HIGHLAND AVE MKD (USC+GS F 96)	BG 2350
COVINA (1965)	546.149	L+T S CB HUNTINGTON DR 35FT E BCR @ SE COR MOUNT OLIVE DR 70FT E 42FT S C/L INT	BG 2354
COVINA (1965)	556.503	RDBM TAG S CB 4FT W BCR @ SW COR HUNTINGTON DR + CRESTFIELD DR 42FT S + 60FT W C/L INT	BG 2355
COVINA (1965)	557.792	RDBM TAG S CB 3FT E BCR @ SE COR HUNTINGTON DR + CRESTFIELD DR 42FT S + 62FT E C/L INT	BG 2356
COVINA (1965)	527.939	CS TAG E CB 12FT S BCR @ SE COR IRWINDALE AVE + 1ST ST 44FT S + 35FT E C/L INT	BG 2357
COVINA (1965)	514.240	L+T E CB 5FT S BCR @ SE COR IRWINDALE AVE + PARAMOUNT ST 53FT S + 33FT E C/L INT	BG 2358
COVINA (1965)	467.439	L+BRAD NE COR CONC SLAB OF STA @ SW COR ARROW HWY + IRWINDALE AVE 60FT S + 72FT W C/L INT	BG 2359
COVINA (1965)	457.157	L+T E CB LFT N BCR @ COR IRWINDALE AVE + CALLE DE PASEO 50FT E + 66FT N C/L INT	BG 2360
COVINA (1965)	456.730	RDBM TAG S CB CALLE DE PASEO @ SE COR IRWINDALE AVE 98FT E + 22FT S C/L INT	BG 2361
COVINA (1965)	380.363	RDBM TAG N END CATCH BASIN IN E CB SUNSET AVE 40FT E C/L + 366FT N C/L SERV AVE	BG 2365
COVINA (1965)	361.995	L+T E CB 36FT N BCR @ COR SUNSET AVE + MERCED AVE 100FT N + 40FT E C/L INT	BG 2368
COVINA (1965)	501.331	L+BN CONC FTG 6FT CHAIN LINK FENCE POST @ ANG PT ALONG RR 21FT N C/L PVMT GLADSTONE ST + 750FT E C/L IRWINDALE AVE MKD (BM)	BG 2370
COVINA (1965)	505.318	CS MON IN WELL 24IN DN @ PROPOSED C/L INT GLADSTONE ST + VINCENT AVE (L.A. CO SURVEYOR)	BG 2372
COVINA (1965)	507.610	AZUSA BR CAP IN E CB @ COR GLADSTONE ST + JACKSON AVE 15FT E + 60FT N C/L INT MKD (BM 55-44 AZUSA)	BG 2374
COVINA (1965)	505.417	L+T CB 1FT S BCR @ SE COR GLADSTONE ST + CLYDEBANK AVE 15FT E + 15FT S C/L INT	BG 2375
COVINA (1965)	510.150	CS MON IN WELL 8IN DN @ C/L INT GLADSTONE ST + SUNSET AVE MKD (RD 63)	BG 2376
COVINA (1965)	518.718	CS MON FLUSH @ NE COR GLADSTONE ST + AZUSA AVE 45FT E + 80FT N C/L INT MKD (BM 11-26A)	BG 2377
COVINA (1965)	549.670	RD MON IN WELL 8IN DN @ C/L INT GLADSTONE ST + CERRITOS AVE MKD (L.A. CO RD DEPT 1950)	BG 2379
COVINA (1965)	575.856	RDBM TAG S CB 1FT W BCR @ SW COR GLADSTONE ST + FENIMORE AVE 30FT S + 50FT W C/L INT	BG 2382
COVINA (1965)	577.311	RDBM TAG S CB 12FT E BCR @ SE COR GLADSTONE ST + FENIMORE AVE 30FT S + 66FT E C/L INT	BG 2383
COVINA (1965)	375.158	L+BN CONC FTG OF W GATE POST 50FT N C/L ARROW HWY + 66FT W C/L LIVE OAK AVE (OLD ARROW HWY) MKD (BM)	BG 2384

QUAD-YEAR	ELEV	DESCRIPTION (INCLUDE QUAD AND YEAR IN DESCRIPTION)	BM NUMBER
COVINA (1965)	427.112	RD MON IN WELL 8IN DN @ C/L INT ARROW HWY (NEW) +MAINE AVE MKD (RD DEPT)	BG 2386
COVINA (1965)	436.881	RD MON 8IN DN @ C/L INT ARROW HWY + BLEEKER ST MKD (LA CO RD 1950)	BG 2387
COVINA (1965)	445.021	RD MON IN WELL @ C/L INT ARROW HWY + ELTON AVE MKD (1950)	BG 2388
COVINA (1965)	457.037	CS MON IN WELL 10IN DN @ C/L ARROW HWY + AZUSA CANYON RD	BG 2389
COVINA (1965)	463.407	CS MON IN WELL 15IN DN @ C/L INT ARROW HWY + FOURTH ST MKD (AZUSA 1-12A)	BG 2390
COVINA (1965)	476.959	RD MON IN WELL 10IN DN @ C/L INT ARROW HWY + CLYDEBANK AVE	BG 2391
COVINA (1965)	484.079	CS MON IN WELL 8IN CN @ C/L INT ARROW HWY + LARK ELLEN	BG 2392
COVINA (1965)	328.453	L+T CONC WK OF HSE @ NW COR COGSWELL RD + LOWER AZUSA RD 75FT N + 25FT W C/L INT	BG 2393
COVINA (1965)	346.593	RDBM TAG W END OF S CB OF BRIDGE NO 81315 15FT S C/L LOWER AZUSA RD + 1000FT W RIVERGRADE RD	BG 2394
COVINA (1965)	348.022	RDBM TAG W END OF N CB OF BRIDGE NO 81315 15FT N C/L LOWER AZUSA RD 1000FT W RIVERGRADE RD	BG 2395
COVINA (1965)	338.668	CDE MON IN S CONC FOOTING OF MIDDLE TOWER NO 109-4 NW COR LOWER AZUSA RD + RIVERGRADE RD 200FT W + 75FT N C/L INT	BG 2396
COVINA (1965)	322.578	L+BN IN W CONC BASE OF UNIOIGN @ NE COR LOWER AZUSA RD + RIVERGRADE RD 50FT N + 48FT E C/L INT	BG 2397
COVINA (1965)	324.898	L+BRAD W END CONC GAS ISL @ NE COR LOWER AZUSA RD + RIVERGRADE RD 185FT S + 42FT N C/L INT MKD (BM)	BG 2398
COVINA (1965)	300.985	RDBM TAG S CB 1FT E BCR @ SW COR SAN BERNARDINO RD + LA MADERA AVE 100FT S + 43FT W C/L INT	BG 2401
COVINA (1965)	300.610	RDBM TAG S CB 1FT W BCR @ SW COR SAN BERNARDINO RD + LA MADERA AVE 100FT S + 43FT E C/L INT	BG 2402
COVINA (1965)	316.785	CS MON IN WELL 24IN DN APPROX C/L GILMAN RD + 60FT S C/L SAN BERNARDINO RD	BG 2403
COVINA (1965)	319.720	L+T CONC SLAB NW COR OF PUEBLO @ SE COR RAMONA BLVD + BARNES AVE 40FT S + 50FT E C/L INT	BG 2405
COVINA (1965)	325.430	RDBM TAG W CB 1FT N BCR @ SE COR RAMONA BLVD + FRANCISQUITO AVE 130FT S + 20FT E C/L INT	BG 2406
COVINA (1965)	364.089	RD MON IN WELL 6IN DN @ SE COR SIERRA MADRE AVE 114FT S C/L RAMONA BLVD MKD (LA CO RD DEPT)	BG 2409
COVINA (1965)	363.481	CS MON IN WELL 18IN DN NR C/L INT RAMONA BLVD + SIERRA MADRE AVE MKD (CO SUR 1952)	BG 2410
COVINA (1965)	374.367	CS MON IN WELL IN E END OF BUS STOP AREA BTW PE TRACKS + E LANE RAMONA BLVD @ W C/L MAINE AVE + 26FT S OF S RAIL MKD (PUENTE E-2B 1954) USED E EDGE	BG 2411

QUAD-YEAR	ELEV	DESCRIPTION (INCLUDE QUAD AND YEAR IN DESCRIPTION)	BM NUMBER
COVINA (1965)	396.323	RDBM TAG W CB 1FT S BCR @ OUT SAN BERNARDINO RD + PUENTE AVE 52FT S + OUT W C/L INT	BG 2413
COVINA (1965)	402.645	RD MON IN WELL 9IN DN ON SAN BERNARDINO RD @ 1ST PI W AZUSA CANYON RD	BG 2414
COVINA (1965)	411.600	L+T N CB SAN BERNARDINO RD 30FT N C/L + 110FT W C/L NORA AVE NR CONC DRAIN THRU ISL	BG 2415
COVINA (1965)	410.701	BT SPK S CB 2FT E BCR @ SE COR SAN BERNARDINO RD + NORA AVE 70FT S + 48FT E C/L INT MKD (SD 101)	BG 2416
COVINA (1965)	422.593	RDBM TAG S CB OF SERVICE OUT SW COR SAN BERNARDINO RD + WALNUT HAVEN DR 128FT W + 70FT S C/L INT	BG 2417
COVINA (1965)	430.864	SQ HD SPK W CB 6FT S BCR @ OUT SW COR SAN BERNARDINO RD + HARTLEY AVE 105FT S + 15FT W C/L INT MKD (HV 78)	BG 2418
COVINA (1965)	432.994	CS TAG N CB 7FT E OF SERV R OUT BCR @ NE COR SAN BERNARDINO RD + HARTLEY AVE 38FT E + 30FT N C/L INT	BG 2419
COVINA (1965)	438.309	CS TAG S CB 75FT E BCR @ OUT SE COR SAN BERNARDINO RD + VINCENT AVE 30FT S + 140FT E C/L INT	BG 2420
COVINA (1965)	462.196	CS MON IN WELL @ SE COR LARK OUT AVE + SAN BERNARDINO RD 53FT E + 11FT S OUT INT MKD (BM 45-9)	BG 2421
COVINA (1965)	478.627	RDBM TAG S CB 1FT W BCR @ OUT COR SAN BERNARDINO RD + RIMSDALE AVE 30FT S + 14FT W C/L INT	BG 2422
COVINA (1965)	480.153	RDBM TAG N CB 1FT E CBR @ OUT SW COR SAN BERNARDINO RD + RIMSDALE AVE 30FT N + 62FT E C/L INT	BG 2423
COVINA (1965)	490.176	STATE HWY MON IN WELL 16IN DN @ C/L INT AZUSA AVE + SAN BERNARDINO RD	BG 2424
COVINA (1965)	502.131	BT SPK N CB 2FT E BCR @ NE COR CYPRESS ST + AZUSA AVE 30FT N + 82FT E C/L INT MKD (SD 125)	BG 2426
COVINA (1965)	529.147	BT SPK S CB 40FT E BCR @ SE COR CYPRESS ST + HOLLENBECK AVE 30FT S + 102FT E C/L INT MKD (BM 17-3A)	BG 2427
COVINA (1965)	549.711	RDBM TAG W CB 2FT S BCR @ SW COR CYPRESS ST + FENIMORE AVE 52FT S + 18FT W C/L INT	BG 2428
COVINA (1965)	549.928	RDBM TAG S CB 15FT E BCR @ SE COR CYPRESS ST + FENIMORE AVE 62FT E + 30FT S C/L INT	BG 2429
BASELINE (1965)	563.803	CS MON 8IN DN ON SE COR CYPRESS AVE + CITRUS AVE 1FT BACK CB 40FT S + 31FT E C/L INT MKD (BM 17 3A)	BG 2430
BASELINE (1965)	580.218	RDBM TAG IN CB 1FT N BCR @ NE COR GRAND AVE + ROWLAND AVE 30FT N + 40FT E C/L INT	BG 2434
BASELINE (1965)	580.545	CS TAG IN CB 1FT S BCR @ NW COR GRAND AVE + ROWLAND AVE 45FT W + 55FT N C/L INT	BG 2435
COVINA (1965)	409.310	COE MON IN W CB AZUSA CANYON RD 18FT W C/L + 263FT S C/L LOS ANGELES ST MKD (COE BD NO 8)	BG 2436
COVINA (1965)	433.189	CS MON IN WELL @ C/L INT OUT AZUSA CANYON RD + OLIVE ST MKD (1/4 SEC 8/9 T1S R1E 1177)	BG 2440

QUAD-YEAR	ELEV	DESCRIPTION (INCLUDE QUAD AND YEAR IN DESCRIPTION)	BM NUMBER
COVINA (1965)	435.739	L+T S CB ALLEY 160FT N OLIVE ST 1FT E BCR @ SW COR AZUSA CANYON RD + ALLEY 38FT W + 10FT S C/L INT	BG 2441
COVINA (1965)	446.797	L+T IN S CB NUBIA ST 1FT W BCR @ SW COR AZUSA CANYON RD 69FT W + 20FT S C/L INT	BG 2443
COVINA (1965)	447.757	L+BN E CB 10FT S GENERAL TELEPHONE CO DR 32FT E C/L AZUSA CANYON RD + 45FT N C/L NUBIA ST PROD	BG 2444
BASELINE (1965)	334.634	RDBM TAG N CB 36FT W BCR 113FT W + 30FT N C/L INT FRANCISQUITO AVE + PUENTE AVE	BG 2445
COVINA (1965)	465.708	L+T N CB 1FT E BCR @ NE COR FRANCISQUITO AVE + GLENVIEW RD 20FT N + 45FT E C/L INT	BG 2448
COVINA (1965)	509.618	L+T W CB HOLLENBECK ST 1FT N BCR @ NW COR VINE ST	BG 2449
BASELINE (1965)	440.322	CS MON IN WELL 24IN DN @ PIQUET PASS COVINA RD 400FT S WITZMAN DR	BG 2479
BASELINE (1965)	443.220	CS MON IN WELL 12IN DN @ PIQUET PASS + COVINA RD 122FT S CALCUTTA ST 23FT W OF PP NO 858714E	BG 2480
COVINA (1965)	366.226	BT SPK E CB PUENTE AVE 150FT S C/L CLYDEWOOD AVE	BG 2481
COVINA (1965)	365.003	CS MON IN WELL 10IN DN ON C/L PUENTE AVE @ ANGLE PT 190FT S CLYDEWOOD AVE MKD (RE 2177)	BG 2482
COVINA (1965)	348.498	CS MON IN WELL 18IN DN @ C/L INT MERCED AVE + PUENTE AVE	BG 2483
BASELINE (1965)	296.369	CS MON IN WELL 12IN DN 1FT E CB @ SE COR FORREST GROVE ST + PECK RD 71FT S + 41FT E C/L INT	BG 2635
BASELINE (1965)	313.469	CS BR CAP FLUSH IN CONC LIGHT BASE FOR GAS STA @ SW COR PECK RD + LAMBERT AVE 40FT S + 47FT W C/L INT MKD (15-3-A 1963)	BG 2636
BASELINE (1965)	353.760	FC BR CAP IN S END W WINGWALL OF BRIDGE NO 964 @ SE COR PECK RD + LIVE OAK ST 48FT S + 82FT E APPROX C/L INT MKD (67-76 1959)	BG 2637
BASELINE (1965)	386.800	L+SPK IN W CB 6FT S BCR 55FT S + 45FT W C/L INT E ALTERN ST + S MYRTLE AVE MKD (LE 85)	BG 2638
BASELINE (1965)	387.346	L+SPK S CB E ALTERN ST 10FT E BCR 20FT S + 79FT E C/L INT S MYRTLE AVE + E ALTERN ST	BG 2639
BASELINE (1965)	432.055	L+T E CB 15FT N BCR 75FT S + 43FT E C/L INT DUARTE RD + S MYRTLE AVE	BG 2640
BASELINE (1965)	437.616	L+T E CB S MYRTLE AVE 24FT S BCR 54FT N + 29FT E C/L INT DUARTE RD + S MYRTLE AVE	BG 2641
BASELINE (1965)	499.528	CE MON FLUSH IN WLK BACK OF CB 30FT E BCR @ SE COR HUNTINGTON DR + MYRTLE AVE 126FT E + 36FT S C/L INT MKD (11-10A RE 5869 CE)	BG 2642
COVINA (1965)	526.484	BR DISC FLUSH CTR BRIDGE 53-44 N SIDE HUNTINGTON DR 450FT W MOUNTAIN AVE MKD (CORP OF ENG)	BG 2643
COVINA (1965)	600.300	L+BR 5FT S BCR @ NW COR FOOTHILL BLVD + CONEY AVE 70FT N + 20FT W C/L INT	BG 2644
COVINA (1965)	600.353	L+BR 5FT S BCR @ NE COR FOOTHILL BLVD + CONEY AVE 70FT N + 20FT E C/L INT	BG 2645

QUAD-YEAR	ELEV	DESCRIPTION (INCLUDE QUAD AND YEAR IN DESCRIPTION)	BM NUMBER
COVINA (1965)	606.543	CITY OF AZUSA BR MON FLUSH IN E CB @ NE COR FOOTHILL BLVD + VERNON AVE 126FT N + 21FT E C/L INT MKD (BM 56-1 AZUSA)	BG 2646
COVINA (1965)	606.053	L+BR IN N CB SERVICE ISLAND NE COR Foothill Blvd + VERNON AVE 63FT N + 30FT E C/L INT	BG 2647
COVINA (1965)	606.552	L+TRAN TACK MCR NW COR Foothill Blvd + Azusa Ave 43FT N + 30FT W C/L INT	BG 2648
COVINA (1965)	606.295	L+TRAN TACK MCR NE COR Foothill Blvd + Azusa Ave 43FT N + 30FT E C/L INT	BG 2649
COVINA (1965)	602.453	L+BN N CB Foothill Blvd 30FT N C/L + 200FT W C/L PROD ALOSTA AVE (NR CONC LT STD)	BG 2650
COVINA (1965)	607.019	CS MON IN WELL 8IN DN @ OR NR C/L INT Foothill Blvd + Rockvale Ave MKD (CO SUR RE 63) USE H EDGE	BG 2651
BASELINE (1965)	625.380	RD TAG IN E CB 30FT S BCR @ SE COR Citrus Ave + Foothill Blvd 80FT S + 40FT E C/L INT	BG 2652
BASELINE (1965)	625.439	CS MON NR C/L INT Citrus Ave + Foothill Blvd TO THE W	BG 2653
BASELINE (1965)	589.038	CSBM MON IN WINGWALL OF BRIDGE NO 1408 NE COR Grand Ave + Badillo St 80FT N + 50FT E MKD (BM 17-8B 1963)	BG 2654
BASELINE (1965)	586.651	R D MON @ C/L INT Gladstone Ave + Citrus Ave	BG 2655
COVINA (1965)	551.634	CS MON IN WELL 8IN DN @ C/L INT Cerritos Ave TO THE S + Gladstone St MKD (A-11 RE 63)	BG 2656
COVINA (1965)	537.588	CE BR CAP FLUSH IN E END OF CATCH BASIN 1FT BACK OF N CB 15FT E BCR 31FT N + 68FT E C/L INT Gladstone St + Pasadena Ave MKD (11-27A RE 5869)	BG 2657
BASELINE (1965)	570.698	COE BR CAP W CB 90FT N BCR + 140FT N + 40FT W C/L INT Tudor St + Citrus Ave MKD (SD 6-1956)	BG 2658
BASELINE (1965)	565.441	CS TRI MON IN WELL 12IN DN @ OR NR C/L INT Citrus Ave + Covina Blvd MKD (COVINA BL 1957)	BG 2659
BASELINE (1965)	566.085	RD HD SPK IN W CB 67FT S BCR @ SW COR Citrus Ave + Covina Blvd 110FT S + 35FT W C/L INT MKD (BM NO 139)	BG 2660
BASELINE (1965)	560.759	USC+GS BR CAP S END CATCH BASIN 40FT E C/L Citrus Ave 35FT S OF BENBOW ST MKD (K1149 1961)	BG 2661
BASELINE (1965)	553.637	RDBM TAG E CB 1FT N BCR @ NE COR SAN BERNARDINO RD + Citrus Ave 27FT E + 44FT N C/L INT	BG 2663
BASELINE (1965)	552.851	RDBM TAG W CB 1FT S BCR @ SW COR SAN BERNARDINO RD + Citrus Ave 27FT W + 37FT S C/L INT	BG 2664
BASELINE (1965)	541.653	CS TRI MON IN WELL 10IN DN @ OR NR C/L INT Badillo St + Citrus Ave MKD (COVINA B2 1957)	BG 2665
BASELINE (1965)	560.462	RDBM TAG N CB 16FT E BCR @ NE COR Badillo St + Barranca Ave 40FT N + 70FT E C/L INT	BG 2666
BASELINE (1965)	587.546	RDBM TAG S CB 5FT W BCR @ SW COR Grand Ave + Badillo St 40FT S + 74FT W C/L INT E END CATCH BASIN	BG 2667

QUAD-YEAR	ELEV	DESCRIPTION (INCLUDE QUAD AND YEAR IN DESCRIPTION)	BM NUMBER
BASELINE (1965)	521.982	COE BR MON IN CB OF ISLAND @ OAK CN RD 36FT S C/L COVINA HILLS RD MKD (W C 28 1957)	BG 2668
BASELINE (1965)	528.794	CS MON IN WELL 10IN DN 9FT SW + 12FT SE C/L INT COVINA HILLS RD + CHAPARRO RD MKD (BM 17-11 1952)	BG 2669
BASELINE (1965)	635.682	CS MON 12IN WELL W/COVER 0.55MI E CHAPARRO RD + 8FT S C/L COVINA HILLS RD MKD (BM 17-12 1952 RE 63)	BG 2670
BASELINE (1965)	652.202	CS MON 12IN DN IN WELL W/COVER 20FT W + 10FT N C/L INT COVINA HILLS RD + HOLT AVE MKD (BM 17-13 1952 RE 63)	BG 2671
BASELINE (1965)	733.455	CS MON 12IN DN IN WELL W/COVER 0.4MI E C/L HOLT AVE + 8FT SE C/L COVINA HILLS RD MKD (BM 17-14 1952 RE 63)	BG 2672
BASELINE (1965)	865.999	CS MON 12IN DN IN WELL W/COVER 0.8MI E ALONG COVINA HILLS RD FROM INT HOLT AVE + 26FT E CTR PRIVATE DRIVE TO HSE NO 21144 MKD (BM 17-15 1952 RE 63)	BG 2673
BASELINE (1965)	865.667	CS MON IN WELL 10IN DN ON C/L PVMT COVINA HILLS RD NR C/O DR TO HSES NO 21542 + NO 21554 MKD (BM 17-16 1952)	BG 2674
BASELINE (1965)	774.886	COE BR MON FLUSH IN WINGWALL OF DRAIN TO SAN JOSE CR CHANNEL 36FT E C/L HOLT AVE + 100FT S BRIDGE NO 53-107 MKD (TS J 110 1960)	BG 2675
BASELINE (1965)	702.956	R D MON IN WELL 10IN DN @ OR NR C/L INT POMONA BLVD + TEMPLE AVE MKD (L A CO RD DEPT 1962)	BG 2677
BASELINE (1965)	703.771	L+T 1FT N BCR @ NE COR POMONA BLVD + TEMPLE AVE 40FT N + 40FT E APPROX C/L INT	BG 2678
BASELINE (1965)	685.204	RDBM TAG N CB NR CATCH BASIN ON NE COR POMONA BLVD + VALLEY BLVD 42FT N + 360FT E APPROX C/L INT	BG 2679
BASELINE (1965)	675.487	CSBM FLUSH WITH WALK @ NW COR BRIDGE OVER FC STORM DRAIN (SAN JOSE CR) 40FT N C/L VALLEY BLVD + 0.4MI W INTO POMONA BLVD + VALLEY BLVD MKD (BM 11-91A 1962)	BG 2680
BASELINE (1965)	661.251	L+BN COR OF CONC BOX (CATCH BASIN) ON NW COR VALLEY BLVD @ ENT TO LANDFILL NO 2 30FT N + 50FT W APPROX C/L INT	BG 2681
BASELINE (1965)	645.166	L+BN COR CONC BOX (CATCH BASIN) 25FT NW C/L VALLEY BLVD + NR EC OF CURVE NR STA 114+00 200FT NE OF WATER CO MH 0.8MI E SAN JOSE HILLS RD	BG 2682
BASELINE (1965)	578.013	L+T IN CONC APRON OF GAS STA ON SE COR VALLEY BLVD + BREA CN RD 45FT OUT 90FT E OF APPROX C/L INT	BG 2683
BASELINE (1965)	576.833	RDBM TAG IN CONC FTG OF 5IN IP GUARD OF 24IN WATER LINE @ SE COR VALLEY BLVD + BREA CN RD 130FT S + 50FT E OF APPROX C/L INT	BG 2684
BASELINE (1965)	548.063	FC BR MON FLUSH IN HDWL OF SPRR TRACK ON N COR VALLEY BLVD + CARREY RD 220FT E + 81FT S OF APPROX C/L INT MKD (L A CO FCD BM 102-18 1956)	BG 2685
BASELINE (1965)	544.945	CSBM MON IN WELL 10IN DN ON SW COR VALLEY BLVD + CARREY RD 22FT W + 14FT S OF APPROX C/L INT MKD (BM 11-97 1952)	BG 2686

QUAD-YEAR	ELEV	DESCRIPTION (INCLUDE QUAD AND YEAR IN DESCRIPTION)	BM NUMBER
BASELINE (1965)	518.059	R D MON IN WELL 8IN DN ON C/L VALLEY BLVD + 100FT W C/L LEMON RD MKD (L A CO RD DEPT 196)	BG 2688
BASELINE (1965)	515.356	FC BR DISK E END HOWL 1210FT W LEMCN RD + 22FT N OF N RAIL SPRR 70FT S C/L VALLEY BLVD MKD (FCD 8M 102-14 1956)	BG 2689
BASELINE (1965)	508.450	R D MON IN WELL OUT OR NR C/L INT VALLEY BLVD + CASTLEHILL OR MKD (L A CO RD DEPT 196)	BG 2690
BASELINE (1965)	510.027	RDBM TAG IN N CB VALLEY BLVD 1FT E BCR @ NE COR CASTLEHILL RD + VALLEY BLVD 40FT N + 75FT E C/L INT	BG 2691
BASELINE (1965)	489.017	CS BR CAP @ NW COR CATCH BASIN 41FT S + 270FT E C/L INT OF VALLEY BLVD + CAMINO DE THEODOR MKD (BM 1962 RE 5869)	BG 2692
BASELINE (1965)	470.606	R D MON IN WELL 8IN DN @ OR NR C/L INT VALLEY BLVD + SENTOUS AVE	BG 2693
BASELINE (1965)	482.221	RDBM TAG NW COR OF 3X3FT CONC BASE OF BREATHER PIPE 58FT S C/L VALLEY BLVD + 700FT E SENTOUS AVE (PIPE PAINTED YELLOW)	BG 2694
BASELINE (1965)	456.201	CS TRI MON IN CONC 4IN DN ON SE COR VALLEY BLVD + NOGAL AVE OUT 10FT S + 23FT E APPROX C/L INT MKD (COVINA B-12 1958)	BG 2695
BASELINE (1965)	398.356	CITY OF INDUSTRY BM BR MON FLUSH IN HDWL 40FT S C/L VALLEY BLVD + 18FT E C/L GIANO AVE MKD (NO V 26)	BG 2696
BASELINE (1965)	433.709	CS MON IN WELL 8 IN DN ON C/L PASS + COVINA RD 0.95MI N VALLEY BLVD @ INT OF OUT PROLONGATION @ NLY SIDE HSE NO 240 500FT OUT TEMPLE AVE MKD (BM 37-2 1954)	BG 2697
BASELINE (1965)	422.401	FC BR MON 3IN UP ON NW COR PASS + COVINA RD + AMAR RD 20FT N + 100FT OUT INT MKD (BM 100-27)	BG 2698
COVINA (1965)	460.637	RDBM TAG CONC WINGWALL OF OUT SPILLWAY 70FT S LA PUENTE RD + 130FT E C/L OUT NOGALES ST.	BG 2699
COVINA (1965)	702.856	R D MON IN WELL 8IN DN @ OR NR C/L INT OF VALLEY BLVD + TEMPLE AVE MKD (L A CO RD DEPT 1962)	BG 2700
COVINA (1965)	703.226	RDBM TAG IN N CB ABT 3FT W CATCH BASIN @ NW COR VALLEY BLVD + TEMPLE AVE 73FT W + 40FT N C/L INT	BG 2701
COVINA (1965)	700.382	R D MON @ PI OF TEMPLE AVE + COLLINS ST MKD (L A CO RD 1962)	BG 2702
COVINA (1955)	718.827	BEGINNING @ INT VALLEY BLVD + TEMPLE AVE THENCE ALONG TEMPLE AVE 0.6MI TO RDBM TAG IN ISLAND CB NR C/L	BG 2703
COVINA (1965)	762.708	BEGINNING @ INT OF VALLEY BLVD + TEMPLE AVE THENCE N ALONG TEMPLE AVE 0.8MI TO 2IN IP WITH BM TAG 2IN DN ON C/L @ BC	BG 2704
COVINA (1965)	803.095	BEGINNING @ INT VALLEY BLVD + TEMPLE AVE THENCE N ALONG TEMPLE AVE 1MI TO RDBM TAG IN N CB 43FT E APPROX C/L @ CATTLE UNDERPASS	BG 2705
COVINA (1965)	773.015	BEGINNING @ INT OF VALLEY BLVD + TEMPLE AVE THENCE N ALONG TEMPLE AVE 1 1/4MI TO RDBM TAG IN CONC CB @ ISLAND TURN THRU NR C/L	BG 2706

QUAD-YEAR	ELEV	DESCRIPTION (INCLUDE QUAD AND YEAR IN DESCRIPTION)	BM NUMBER
COVINA (1965)	752.276	BEGINNING @ INT VALLEY BLVD + TEMPLE AVE THENCE N ALONG TEMPLE AVE 1 1/2MI TO RDBM TAG IN CONC CB @ ISLAND TURN AROUND NR C/L	BG 2707
COVINA (1965)	743.877	RDBM TAG IN E CB @ CATCH BASIN ON NE COR TEMPLE AVE + MOST DR TO PARKING LOT 60FT N C/L + 1/2MI E SAN JOSE HILLS RD	BG 2708
COVINA (1965)	719.401	RDBM TAG CTR/CONC END/ISL 5FT E C/L SAN JOSE HILLS RD + 50FT N C/L TEMPLE AVE	BG 2709
COVINA (1965)	731.908	CSBM IN 2ND LIGHT STD OF MT SAC PARKING LOT 75FT E + 90FT N C/L INT GRAND AVE + TEMPLE AVE MKD (BM 17-31 1963)	BG 2710
COVINA (1965)	781.217	RDBM TAG CONC CB @ END ISLAND 5FT E + 40FT S C/L INT GRAND AVE + MOUNTAINEER RD	BG 2711
COVINA (1965)	786.118	RDBM TAG N CB @ CATCH BASIN ON NE COR GRAND AVE + MOUNTAINEER RD 30FT N + 90FT E APPROX C/L INT	BG 2712
COVINA (1965)	964.523	CSBM IN WALK @ E END CATCH BASIN ON NE COR GRAND AVE + COLLEGE VISTA DR MKD (BM 17-28)	BG 2713
COVINA (1965)	871.642	BEGINNING @ INT GRAND AVE + TEMPLE AVE THENCE N ALONG GRAND AVE 1.6MI + 20FT S APPROX C/L TO CSBM BR MON FLUSH IN CONC HDWL OF BRIDGE NO 574 MKD (17-27)	BG 2714
COVINA (1965)	585.136	CS MON IN WELL 8IN DN @ OR NR C/L INT GRAND AVE CORTEZ ST MKD (CO SUR RE 536)	BG 2715
COVINA (1965)	532.071	RDBM TAG N END OF ISLAND CONC CB 50FT S + 5FT W APPROX C/L INT GRAND AVE + HOLLY AVE	BG 2717
COVINA (1965)	531.116	RDBM TAG S END OF ISLAND CONC CB 50FT N + 5FT E APPROX C/L INT GRAND AVE + HOLLY AVE	BG 2718
COVINA (1965)	561.418	CS MON IN WELL @ PI OF BARRANCA ST NR C/L INT CAMERON AVE + BARRANCA ST MKD (CO ENG RE 5869)	BG 2719
COVINA (1965)	524.127	CS MON IN WELL 10IN DN @ OR NR C/L INT CITRUS AVE + CAMERON AVE MKD (CO SUR RE 63)	BG 2720
COVINA (1965)	561.814	L+BN E CB @ N END LONG CURVE 30FT E + 100FT N C/L INT CITRUS AVE + VINE ST MKD (BM)	BG 2721
COVINA (1965)	563.021	L+BR W CB 3FT S BCR @ NW COR CITRUS AVE + VINE ST 53FT N + 30FT W C/L INT	BG 2722
COVINA (1965)	511.009	RAM SET S CB 6FT W BCR @ SW COR HOLLENBECK ST + VINE AVE 20FT S + 76FT W C/L INT	BG 2723
COVINA (1965)	528.494	L+T S CB 1FT W BCR @ SW COR MERCED AVE + HOLLENBECK ST 20FT S + 50FT W C/L INT	BG 2724
COVINA (1965)	527.709	RDBM TAG N CB 1FT W BCR @ NW COR MERCED AVE + HOLLENBECK ST 20FT N + 72FT W C/L INT	BG 2725
BASELINE (1965)	343.043	CS MON IN WELL 8IN DN @ C/L INT FRANCISQUITO AVE + CALIFORNIA AVE MKD (RE 5869 CO ENG MON)	BG 2726
BASELINE (1965)	335.204	CS BR CAP MON FLUSH IN BASE OF TRAFFIC SIGNAL @ SW COR FRANCISQUITO AVE + PUENTE AVE 50FT W + 55FT S C/L INT	BG 2727
BASELINE (1965)	320.681	STATE HWY MON 12IN DN @ C/L INT GARVEY AVE + WACO ST	BG 2728

QUAD-YEAR	ELEV	DESCRIPTION (INCLUDE QUAD AND YEAR IN DESCRIPTION)	BM NUMBER
BASELINE (1965)	324.613	STATE HWY MON 12IN DN @ C/L INT GARVEY AVE + TRACY ST	BG 2729
COVINA (1965)	329.717	CS MON 18IN DN @ C/L INT BALDWIN PARK BLVD + FRANCISQUITO AVE	BG 2730
COVINA (1965)	346.677	CS MON 18IN DN @ C/L INT BALDWIN PARK BLVD + MERCED AVE	BG 2731
BASELINE (1965)	310.873	RDBM TAG IN N CB 1FT W END OF CB TO RICHFIELD GAS STA @ NW COR FRAZIER ST + GARVEY AVE 65FT W + 20FT N C/L INT	BG 2732
BASELINE (1965)	310.051	RDBM TAG IN N CB 1FT FROM BCR @ NE COR GARVEY AVE + BESS AVE 35FT N + 20FT E C/L INT	BG 2733
BASELINE (1965)	303.013	L+T SE CONC BASE OF TRANS TOWER 24707 @ NE COR GARVEY AVE + WESTCOTT AVE 120FT E + 55FT N C/L INT	BG 2734
COVINA (1965)	298.509	L+BN IN CONC CULV 35FT E OF RIVERGRADE RD + 415FT N OF N END FREEWAY BRIDGE	BG 2735
COVINA (1965)	297.878	RDBM TAG IN CONC CULV 1FT W C/L RIVERGRADE RD + 385FT N OF N END FREEWAY BRIDGE	BG 2736
COVINA (1965)	297.536	L+N W CB 1FT N BCR @ NW COR EXLINE ST + DURFEE AVE 37FT N + 45FT W C/L INT	BG 2737
BASELINE (1965)	296.478	RDBM TAG N CB 1FT E BCR @ NE COR DURFEE AVE + GARVEY AVE 37FT W + 30FT N C/L INT	BG 2738
COVINA (1965)	296.080	L+T N CB 44FT E BCR @ NE COR PECK RD + RAMONA BLVD 160FT E + 40FT N C/L INT	BG 2739
COVINA (1965)	295.083	RDBM TAG IN S CB 2FT W BCR @ SW COR FERRIS RD + RAMONA BLVD 35FT W + 40FT S C/L INT	BG 2740
COVINA (1965)	306.499	RDBM TAG IN CONC BASE PHONE SW COR RAMONA BLVD + COGSWELL ST 17 FT W + 70FT S C/L INT	BG 2741
COVINA (1965)	309.234	BT SPK CTR CONC DRWY TO HSE NO 3047 PENN MAR AVE 100FT S + 25FT W C/L INT RAMONA BLVD + PENN MAR AVE	BG 2742
COVINA (1965)	311.338	CS MON IN WELL 18IN DN @ C/L MAXSON RD 100FT S C/L RAMONA BLVD	BG 2743
COVINA (1965)	318.345	L+T IN CONC WLK TO HSE NO 3676 BARNES AVE 131FT S + 33FT E C/L INT RAMONA BLVD + BARNES AVE	BG 2744
COVINA (1965)	392.677	CS MON IN WELL 10IN DN @ C/L N + 10FT W C/L INT PUENTE AVE + BADILLO AVE	BG 2745
COVINA (1965)	421.513	RDBM TAG IN CTR CATCH BASIN 76FT E + 30FT N C/L INT AZUSA CN RD + CYPRESS AVE	BG 2746
COVINA (1965)	439.495	CS BM MON FLUSH IN N END BRIDGE NO B 1246 46FT W C/L IRWINDALE AVE + ABT 400FT N CYPRESS ST MKD (BM 16-2A)	BG 2747
COVINA (1965)	439.849	L+B N CB 1FT W BCR @ NW COR CYPRESS ST + ELLEN DR 33FT N + 39FT W C/L INT	BG 2748
COVINA (1965)	439.909	L+T S CB 2FT W BCR @ SW COR CYPRESS ST + ELLEN DR 32FT S + 37FT W C/L INT	BG 2749

QUAD-YEAR	ELEV	DESCRIPTION (INCLUDE QUAD AND YEAR IN DESCRIPTION)	BM NUMBER
COVINA (1965)	448.859	PK IN E CB 1FT S BCR @ SE COR CYPRESS ST + VINCENT AVE 64FT S + 30FT E C/L INT	BG 2750
COVINA (1965)	448.983	SQ HD SPK IN N CB 4FT E BCR @ NE COR CYPRESS ST + VINCENT AVE 68FT E + 30FT N C/L INT	BG 2751
COVINA (1965)	454.998	L+B N CB 13FT W BCR @ NW COR CYPRESS ST + CONEY AVE 51FT W + 30FT N C/L INT TO THE N	BG 2752
COVINA (1965)	454.934	SQ HD SPK S CB 5FT W BCR @ SW COR CYPRESS ST + CONEY AVE 30FT S + 49FT W C/L INT TO THE N	BG 2753
COVINA (1965)	473.626	L+T N CB 3FT E BCR @ NW COR CYPRESS ST + LARK ELLEN AVE 29FT N + 51FT W C/L INT	BG 2754
COVINA (1965)	474.254	L+B N CB N SERVICE RD @ NE COR CYPRESS ST + LARK ELLEN AVE 76FT N + 105FT E C/L INT	BG 2755
COVINA (1965)	486.917	L+BN N CB 1FT E BCR @ NE COR CYPRESS ST + HOMER-EST AVE 68FT E + 32FT N C/L INT MKD (BM)	BG 2756
COVINA (1965)	513.296	SQ HD SPK N CB N SERVICE RD OF CYPRESS ST 8FT W APPROX C/L PROD ELSPETH WAY 70FT N C/L INT CYPRESS ST + ELSPETH WAY	BG 2758
COVINA (1965)	442.317	CS MON 10IN DN IN CS CASE COVER @ C/L INT LARK ELLEN AVE + ROWLAND AVE MKD (CS RE 63)	BG 2759
COVINA (1965)	436.852	CS MON 10IN DN IN CS CASE + COVER @ C/L INT LARK ELLEN AVE + WORKMAN AVE MKD (CS RE 63)	BG 2760
COVINA (1965)	422.697	CS MON IN CONC FLUSH WITH CTR OF PARKWAY ON C/L STUART AVE + 46FT E C/L LARK ELLEN AVE MKD (CSBM 45 5 1955 RE 63)	BG 2761
COVINA (1965)	416.675	CS MON IN CONC FLUSH WITH CTR OF PARKWAY 61FT N + 31FT W C/L INT LARK ELLEN AVE + CAMERON AVE MKD (CSBM 45-4 1955 RE 63)	BG 2762
COVINA (1965)	415.548	FC BR CAP 11IN DN IN WELL W/CS COVER @ C/L INT LARK ELLEN AVE + MERCED AVE MKD (1957)	BG 2763
COVINA (1965)	387.404	CS TRI MON IN WELL 18IN DN @ NE COR ARROW HWY + BUENO RIO DR 30FT N + 40FT E C/L INT MKD (AZUSA B11) CB MKD (BM 43-3)	BG 2764
COVINA (1965)	399.948	BR MON CTR HDWL NO B 1420 49FT W C/L BUENO RIO DR + 40FT S VAN METER DR MKD (BM 67-83 1954)	BG 2765
COVINA (1965)	400.515	L+BR CTR HDWL NO B 1420 48FT E C/L BUENO RIO DR + 36FT N VAN METAR DR	BG 2766
COVINA (1965)	429.194	L+BR CTR HDWL OF DRAIN 40FT W C/L BUENA VISTA ST + 0.2MI S DUARTE CITY LIMITS	BG 2767
COVINA (1965)	431.092	BR MON CTR HDWL OF DRAIN 60FT E C/L BUENA VISTA ST + 0.15MI S DUARTE CITY LIMITS MKD (BM 67-82)	BG 2768
COVINA (1965)	442.905	RDBM TAG W CB 1FT S BCR @ SW COR BUENA VISTA ST KELLWIL WAY 36FT S + 30FT W C/L INT	BG 2769
COVINA (1965)	443.197	RDBM TAG E CB BUENA VISTA ST 30FT E C/L + NR C/L PROD KELLWIL WAY	BG 2770
COVINA (1965)	456.132	L+T E CB 6FT N BCR @ SE COR BUENA VISTA ST + DUARTE RD 69FT S + 31FT E C/L INT	BG 2771
COVINA (1965)	377.194	L+T S CB 15FT W BCR @ SW COR SUNSET AVE + CAMERON AVE 30FT S + 88FT W C/L INT MKD (BM)	BG 2772

QUAD-YEAR	ELEV	DESCRIPTION (INCLUDE QUAD AND YEAR IN DESCRIPTION)	BM	NUMBE
COVINA (1965)	392.675	CE TAG 40FT W C/L SUNSET AVE + 25FT N C/L WORKMAN AVE PRGD	BG	2773
COVINA (1965)	413.046	RDBM TAG W CB 1FT S BCR @ SW COR IRWINDALE AVE + BADILLO AVE 78FT S + 40FT W C/L INT	BG	2774
COVINA (1965)	417.712	RDBM TAG S CB SAN BERNARDINO RD 1FT E BCR @ SW COR IRWINDALE AVE 70FT W + 32FT S NEW C/L INT	BG	2775
COVINA (1965)	418.070	BR CAP MON FLUSH W CB IRWINDALE AVE 12FT N BCR @ SW COR SAN BERNARDINO RD 40FT W + 50FT S NEW C/L INT	BG	2776
COVINA (1965)	433.423	L+BN C/L OF CATCH BASIN 40FT W + 120FT N C/L INT BADILLO ST + VINCENT AVE	BG	2777
COVINA (1965)	433.349	L+T C/L OF CATCH BASIN 40FT E + 120FT N C/L INT BADILLO ST + VINCENT AVE	BG	2778
COVINA (1965)	517.291	CS MON 10IN DN @ C/L INT BADILLO ST + HOLLENBECK AVE MKD (COVINA A2 1957)	BG	2779
COVINA (1965)	338.637	L+N IN CONC BASE @ NW COR OF SCE TOWER NO 109-4 ON THE N SIDE OF LOWER AZUSA RD + W OF RIVERGRADE RD	BG	2780
COVINA (1965)	356.019	CS MON 12IN DN 0.6MI N LOWER AZUSA RD + 38FT NW C/L RIVERGRADE RD MKD (CS TRAV STA PUENTE B-1 1953)	BG	2781
COVINA (1965)	384.708	R D BR CAP 10IN DN IN WELL @ RIVERGRADE RD C/L PI 1/4MI SW FROM OLD C/L ARROW HWY MKD (LA CO RD DEPT 1953)	BG	2782
COVINA (1965)	408.101	CS MON @ SE COR BRIDGE NO B1314 @ SW COR RIVERGRADE RD + LIVE OAK AVE 7FT S OF CB MKD (BM 46-7A)	BG	2783
COVINA (1965)	417.559	L A CO TRAVERSE MON 12IN DN NR INT ARROW HWY + SIERRA MADRE AVE 15FT W + 8FT S APPARENT INT MKD (E 12 A)	BG	2784
COVINA (1965)	397.754	CS MON 12IN DN IN CS CASE + COVER 10FT W C/L INT SIERRA MADRE AVE + OLIVE ST MKD (LA CO SURV CONTROL TRAV STA AZUSA E-12 1953)	BG	2785
COVINA (1965)	379.823	CS MON IN NW COR CATCH BASIN @ NE COR SIERRA MADRE AVE + LOS ANGELES ST MKD (BM 46-10A)	BG	2786
BASELINE (1965)	617.096	CS MON FLUSH IN WK ON SW COR ALOSTA AVE + CITRUS AVE 63FT S + 43FT W C/L INT MKD (BM 4C-12B)	BG	2975
BASELINE (1965)	576.065	SPK 5FT W BCR @ NW COR FOOTHILL BLVD + MYRTLE AVE 45FT W + 30FT N C/L INT	BG	3067
BASELINE (1965)	576.432	L+T CTR CB RET @ SE COR FOOTHILL BLVD + MYRTLE AVE	BG	3068
BASELINE (1965)	554.807	L+T CTR CB RET @ SE COR MYRTLE AVE + LIME AVE	BG	3069
BASELINE (1965)	517.887	L+T CTR CB RET @ NE COR MYRTLE AVE + CHESTNUT AV	BG	3070
BASELINE (1965)	500.122	RAMSET CTR @ NE COR MYRTLE AVE + HUNTINGTON	BG	3071

JUL 1969

LOS ANGELES COUNTY ROAD DEPARTMENT
SURVEY SECTION FIELD ENGINEERING DIVISION

PAGE 25

QUAD-YEAR	ELEV	DESCRIPTION (INCLUDE QUAD AND YEAR IN DESCRIPTION)	BM NUMBER
BASELINE (1965)	470.464	L+T 5FT N BCR @ NW COR MYRTLE AVE + MONTANA AVE 35FT N + 30FT W C/L INT	BG 3072